



## TDA - V / TDA - FV

### Construction

Double flanged casing is produced in mild steel or galvanised steel.

### Finish

Painting or galvanisation after manufacture is normal on all parts.

### Motors

Totally enclosed Class 'F' motors, with a min. IP54 protection, are fitted as standard. High temperature resistant, Class 'H' motors, complying with BS7346 Part 2 1990, Class B, C and D performance, are also available.

### Impeller

The blades are made of Pressure-casted Aluminum and the pitch angle can be adjusted manually.

### Airflow Direction

Air flow from impeller to motor is fitted as standard. Air flow from motor to impeller can be supplied on request.

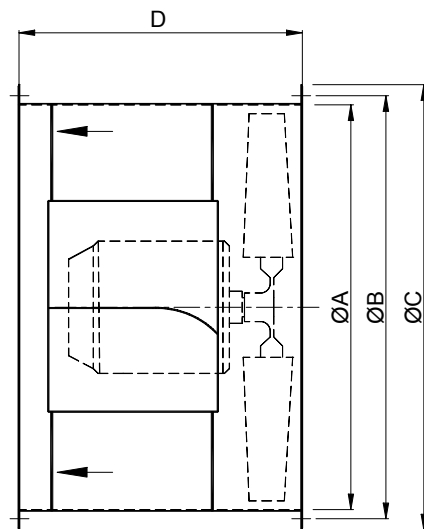
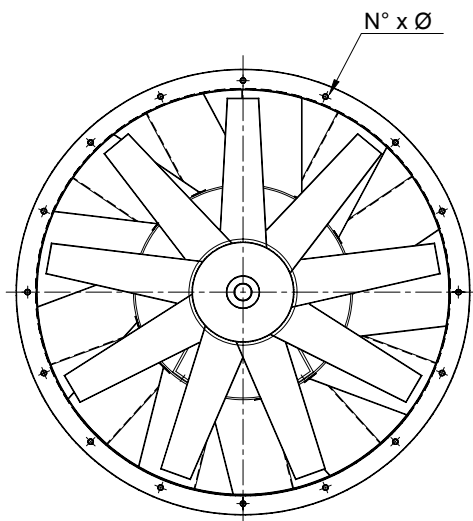

All Dimension in mm.

MODEL	A	B	C	D	N°	Ø	Weight ( kg )	Max.Motor* Frame Size
315	315	355	395	200	8	10	6	D71
355	355	395	435	200	8	10	7	D80
400	400	440	480	235	12	10	7.5	D90S
450	450	490	530	255	12	10	8	D90L
500	500	540	580	285	12	10	11	D90L
560	560	605	660	346	12	10	16	D112M
630	630	675	730	346	12	10	18	D112M

MODEL	A	B	C	D	N°	Ø	Weight ( kg )	Max.Motor* Frame Size
710	710	755	810	406	18	12	30	D112M
800	800	845	900	406	18	12	40	D132M
900	900	945	1000	495	18	12	51	D160M
1000	1000	1050	1100	550	24	12	57	D160M
1120	1120	1185	1250	650	24	12	96	D225M
1250	1250	1315	1380	700	24	12	147	D250M
1400	1400	1465	1530	770	32	14	171	D250M

- Please consult KRUGER for details, if motor frame size exceeds the specified range.
- Fan weight does not include the weight of motor and impeller.