

KC Series

IE1/IE2/IE3/IE4

Three Phase AC Induction motor





Why KRUGER ?

KRUGER has been a leading innovator and manufacturer of residential, commercial and industrial fan application solutions across Asia since 1985. Today with a direct presence in over 18 regions throughout Asia; world class R&D and manufacturing facilities; KRUGER are able to offer their customers unparalleled service and support at a local level. Our customers place their trust in KRUGER.

Why use a KRUGER KC Motor Series?

The KRUGER KC Series motors are premium-grade three-phase TEFC squirrel-cage induction motors designed for high reliability, robust performance, and global compliance.

With efficiency classes ranging from IE1 to IE4, the KC Series delivers optimal operating efficiency for HVAC, industrial, and general-purpose applications.

Developed through extensive benchmarking against leading global motor brands, the KC Series combines high electrical performance, superior mechanical durability, and flexible customization options.



Efficiency Class	Target Application	Benefit
IE1 – Standard	Cost-sensitive segments	Basic energy performance
IE2 – High Efficiency	General industries	Lower lifecycle cost
IE3 – Premium Efficiency	Global industrial standard	Best balance of cost & efficiency
IE4 – Super-Premium Efficiency	Energy-critical industries, AHU, pumps	Ultra-low loss, reduces power bills significantly

Specifications

Description	Standard Specifications	Option
Type of Motor	Squirrel cage induction motor	-
Design standard	IEC 60034, IEC 60038, IEC 60032	NEMA MG-1
Efficiency	IE1 - IE4	Efficiency, Premium efficiency
Frame size	71 - 355	143T - 500T
Enclosure	IP55	IP56, IP65
Voltage and Frequency	For 2.2kW and below: 220-240V (Delta) / 380-415V (Star), 60Hz For 3.0kW and above: 380-415V (Delta) / 660-720V (Star), 60Hz	Other voltages/frequency such as 200V, 346V, 440V, 460V & 50Hz etc. can be supplied on request
Power source conditions	± 5% of Rated voltage	-
Time duty	Continuous duty (S1)	Short-time duty (S2) and other
Service factor (SF)	1.0	1.15 and other
Method of starting	Full voltage direct on line starting or star-delta starting	Inverter duty application
Direction of rotation	Standard motors are suitable for operation in either direction of rotation. Direction of rotation of motor can be reversed by interchanging any two phases	-
Insulation and Temperature rise Environmental conditions	Class F insulation and Class B temperature rise for Normal operating temperature motor - Ambient temperature: -20°C to 40°C - Place: Shadow, Non-hazardous - Relative humidity: Less than 90%RH (non-condensation) - Altitude: Less than 1000 meters	Class H insulation and Class B temperature rise for Smoke extraction motor Designed and tested in accordance with EN 12101-3 standards - Ff250: 250°C for 120 minutes - Ff300, 300°C for 120 minutes - F400, 400°C for 120 minutes
Lubrication	Class F : Lithium-base grease	Class H : Heat resistance silicon thickened grease
Rotor winding	Squirrel cage, aluminium conductor with end-ring and wafer blades integrally cast	-
Cooling method	IC411, Totally-enclosed fan-cooled (TEFC)	IC410: Totally Enclosed Non-Ventilated (TENV) IC418: Totally Enclosed Air Over (TEAO)
Mounting	Foot Mount (B3)	Flange Mount (B5), Foot & Flange Mount (B35), Face Mount (B14)
Shaft	Carbon steel, round shaft with key	-
Bearing	-Motors of frame size 160 and below are fitted with life-lubricated bearings -Motors of frame size 180 and above are fitted with open bearings and regreasing device	-
Painting	Phenolic rust-proof base plus lacquer surface finish	-
Terminal box position	Top	Right or Left hand side
Nameplate	Aluminium or stainless steel	-

Motors can be customized in accordance to customer's requirements:

1. RTD temperature sensor
2. PTC thermister
3. Anti-condensation heater
4. Corrosion-proof
5. Special paint finished
6. Special volt/Hz
7. Extend lead wire
8. Special shaft extension
9. Double ended shaft
10. Grease relief for frames down to 100L
11. Sun canopy
12. Brake motor

IE1 PERFORMANCE DATA:

2 Pole / 60Hz

Model	Rated Power		Frame size	Rated Current(A) (I _{FL})			Rated Speed RPM.	Rated Torque (T _{FL}) N.M	Power Factor (cosΦ)	Efficiency Full load %	Starting Current I _{ST} / I _{FL}	Starting Torque T _{ST} / T _{FL}	Maximum Torque T _M / T _{FL}	Weight (kg)	Moment of inertia (kgm ²)
	Kw	HP		At 380V	At 400V	At 415V									
Y2-711-2	0.37	0.5	71	0.99	0.94	0.91	3300	1.1	0.81	70.0	6.1	2.2	2.2	9	0.0004
Y2-712-2	0.55	0.75	71	1.42	1.34	1.30	3348	1.6	0.82	72.0	6.1	2.2	2.3	9.5	0.0006
Y2-801-2	0.75	1	80	1.86	1.76	1.70	3414	2.1	0.83	74.0	6.1	2.2	2.3	14.5	0.0010
Y2-802-2	1.1	1.5	80	2.53	2.41	2.32	3408	3.1	0.84	78.5	7.0	2.2	2.3	16	0.0011
Y2-90S-2	1.5	2	90S	3.35	3.18	3.07	3408	4.2	0.84	81.0	7.0	2.2	2.3	18.5	0.0023
Y2-90L-2	2.2	3	90L	4.83	4.58	4.42	3408	6.2	0.85	81.5	7.0	2.2	2.3	20.5	0.0030
Y2-100L-2	3	4	100L	6.35	6.03	5.82	3396	8.4	0.87	82.5	7.5	2.2	2.3	29	0.0060
Y2-112M-2	4	5.5	112M	8.15	7.75	7.47	3468	11.0	0.88	84.7	7.5	2.2	2.3	36	0.0075
Y2-132S1-2	5.5	7.5	132S	11.0	10.5	10.1	3492	15.0	0.88	86.0	7.5	2.2	2.3	48	0.0170
Y2-132S2-2	7.5	10	132S	14.8	14.1	13.6	3492	20.5	0.88	87.5	7.5	2.2	2.3	55	0.0180
Y2-160M1-2	11	15	160M	21.7	20.6	19.9	3522	29.8	0.88	87.5	7.5	2.2	2.3	96	0.0601
Y2-160M2-2	15	20	160M	29.3	27.8	26.8	3522	40.7	0.88	88.5	7.5	2.2	2.3	105	0.0671
Y2-160L-2	18.5	25	160L	35.3	33.5	32.3	3522	50.2	0.89	89.5	7.5	2.2	2.3	120	0.0781
Y2-180M-2	22	30	180M	42.0	39.9	38.4	3528	59.5	0.89	89.5	7.5	2.0	2.3	144	0.1181
Y2-200L1-2	30	40	200L	56.8	53.9	52.0	3534	81.1	0.89	90.2	7.5	2.0	2.3	207	0.2052
Y2-200L2-2	37	50	200L	69.0	65.6	63.2	3534	100.0	0.89	91.5	7.5	2.0	2.3	219	0.2302
Y2-225M-2	45	60	225M	83.8	79.6	76.7	3558	120.8	0.89	91.7	7.5	2.0	2.3	280	0.3103
Y2-250M-2	55	75	250M	102	96.5	93.0	3558	147.6	0.89	92.4	7.5	2.0	2.3	366	0.4925
Y2-280S-2	75	100	280S	138	131	126	3558	201.3	0.89	93.0	7.5	2.0	2.3	485	0.6957
Y2-280M-2	90	125	280M	162	154	148	3558	241.5	0.91	93.0	7.5	2.0	2.3	558	0.8529
Y2-315S-2	110	150	315S	197	188	181	3570	294.2	0.91	93.0	7.1	1.8	2.2	875	1.7548
Y2-315M-2	132	180	315M	236	224	216	3570	353.1	0.91	93.5	7.1	1.8	2.2	950	1.8759
Y2-315L1-2	160	215	315L	281	267	257	3570	428.0	0.92	94.1	7.1	1.8	2.2	1010	2.2983
Y2-315L2-2	200	270	315L	351	333	321	3570	535.0	0.92	94.1	7.1	1.8	2.2	1080	2.4805
Y2-355M-2	250	340	355M	444	421	406	3576	667.6	0.91	94.1	7.1	1.6	2.2	1550	3.3243
Y2-355L-2	315	430	355L	559	531	512	3576	841.1	0.91	94.1	7.2	1.6	2.2	1720	3.9890
Y2-355L2-2	355	480	355L	630	598	577	3576	948.0	0.91	94.1	7.2	1.6	2.2	1800	4.6536

IE1 PERFORMANCE DATA:

4 Pole / 60Hz

Model	Rated Power		Frame size	Rated Current(A) (I _{FL})			Rated Speed RPM.	Rated Torque (T _{FL}) N.M	Power Factor (cosΦ)	Efficiency Full load %	Starting Current I _{ST} / I _{FL}	Starting Torque T _{ST} / T _{FL}	Maximum Torque T _M / T _{FL}	Weight (kg)	Moment of inertia (kgm ²)
	Kw	HP		At 380V	At 400V	At 415V									
Y2-711-4	0.25	0.33	71	0.75	0.72	0.69	1620	1.5	0.74	68	5.2	2.1	2.2	8.7	0.0007
Y2-712-4	0.37	0.5	71	1.07	1.02	0.98	1608	2.2	0.75	70	5.2	2.1	2.2	9.4	0.0008
Y2-801-4	0.55	0.75	80	1.51	1.43	1.38	1668	3.1	0.75	74	5.2	2.4	2.3	13.9	0.0016
Y2-802-4	0.75	1	80	1.95	1.85	1.78	1656	4.3	0.76	77	6	2.3	2.3	15.3	0.0019
Y2-90S-4	1.1	1.5	90S	2.78	2.64	2.55	1668	6.3	0.76	79	6	2.3	2.3	18.3	0.0029
Y2-90L-4	1.5	2	90L	3.59	3.41	3.28	1668	8.6	0.78	81.5	6	2.3	2.3	21.6	0.0034
Y2-100L1-4	2.2	3	100L	5.03	4.78	4.61	1692	12.4	0.8	83	7	2.3	2.3	28	0.0085
Y2-100L2-4	3	4	100L	6.70	6.36	6.13	1692	16.9	0.81	84	7	2.3	2.3	32	0.0133
Y2-112M-4	4	5.5	112M	8.72	8.28	7.98	1728	22.1	0.82	85	7	2.3	2.3	39	0.0140
Y2-132S-4	5.5	7.5	132S	11.7	11.1	10.7	1734	30.3	0.82	87	7	2.3	2.3	53	0.0320
Y2-132M-4	7.5	10	132M	15.5	14.7	14.2	1734	41.3	0.84	87.5	7	2.3	2.3	64	0.0400
Y2-160M-4	11	15	160M	22.5	21.4	20.6	1752	60.0	0.84	88.5	7	2.2	2.3	101	0.1010
Y2-160L-4	15	20	160L	30.3	28.8	27.8	1752	81.8	0.84	89.5	7.5	2.2	2.3	112	0.1270
Y2-180M-4	18.5	25	180M	36.1	34.3	33.1	1764	100.1	0.86	90.5	7.5	2.2	2.3	141	0.1700
Y2-180L-4	22	30	180L	42.7	40.6	39.1	1764	119.1	0.86	91	7.5	2.2	2.3	161	0.1900
Y2-200L-4	30	40	200L	57.8	54.9	52.9	1764	162.4	0.86	91.7	7.2	2.2	2.3	212	0.3300
Y2-225S-4	37	50	225S	69.9	66.4	64.0	1770	199.6	0.87	92.4	7.2	2.2	2.3	263	0.5600
Y2-225M-4	45	60	225M	84.5	80.3	77.4	1770	242.8	0.87	93	7.2	2.2	2.3	299	0.6500
Y2-250M-4	55	75	250M	103	98.1	94.6	1770	296.7	0.87	93	7.2	2.2	2.3	383	1.0500
Y2-280S-4	75	100	280S	141	134	129	1782	401.9	0.87	93.2	7.2	2.2	2.3	443	1.2980
Y2-280M-4	90	125	280M	169	160	154	1782	482.3	0.87	93.2	7.2	2.2	2.3	512	1.8100
Y2-315S-4	110	150	315S	203	193	186	1782	589.4	0.88	93.5	6.9	2.1	2.2	895	2.9800
Y2-315M-4	132	180	315M	241	229	221	1782	707.3	0.88	94.5	6.9	2.1	2.2	990	3.4800
Y2-315L1-4	160	215	315L	289	275	265	1782	857.4	0.89	94.5	6.9	2.1	2.2	1065	3.9600
Y2-315L2-4	200	270	315L	361	343	331	1782	1071.7	0.89	94.5	6.9	2.1	2.2	1155	4.4700
Y2-355M-4	250	340	355M	452	429	414	1788	1335.2	0.89	94.5	6.9	2.1	2.2	1650	7.8000
Y2-355L-4	315	430	355L	569	541	521	1788	1682.3	0.89	94.5	6.9	2.1	2.2	1760	9.6000
Y2-355L2-4	355	480	355L	645	612	590	1490	2275.1	0.89	94	6.9	2.1	2.2	1890	11.0400

IE1 PERFORMANCE DATA:

6 Pole / 60Hz

Model	Rated Power		Frame size	Rated Current(A) (I _{FL})			Rated Speed RPM.	Rated Torque (T _{FL}) N.M	Power Factor (cosΦ)	Efficiency Full load %	Starting Current I _{ST} / I _{FL}	Starting Torque T _{ST} / T _{FL}	Maximum Torque T _M / T _{FL}	Weight (kg)	Moment of inertia (kgm ²)
	Kw	HP		At 380V	At 400V	At 415V									
Y2-711-6	0.18	0.24	71	0.79	0.75	0.72	1038	1.7	0.66	52.5	4.0	1.9	2.0	13	0.0011
Y2-712-6	0.25	0.33	71	0.97	0.92	0.89	1038	2.3	0.68	57.5	4.0	1.9	2.0	14	0.0012
Y2-801-6	0.37	0.5	80	1.30	1.23	1.19	1062	3.3	0.70	62.0	4.7	1.9	2.0	14.4	0.0024
Y2-802-6	0.55	0.75	80	1.76	1.67	1.61	1062	4.9	0.72	66.0	4.7	1.9	2.1	15.5	0.0026
Y2-90S-6	0.75	1	90S	2.20	2.09	2.01	1098	6.5	0.72	72.0	5.5	2.0	2.1	17.5	0.0040
Y2-90L-6	1.1	1.5	90L	3.05	2.90	2.80	1098	9.6	0.73	75.0	5.5	2.0	2.1	23	0.0056
Y2-100L-6	1.5	2	100L	3.95	3.75	3.61	1092	13.1	0.75	77.0	5.5	2.0	2.1	27	0.0100
Y2-112M-6	2.2	3	112M	5.60	5.32	5.13	1128	18.6	0.76	78.5	6.5	2.0	2.1	36	0.0160
Y2-132S-6	3	4	132S	7.50	7.12	6.86	1152	24.9	0.76	80.0	6.5	2.1	2.1	48	0.0370
Y2-132M1-6	4	5.5	132M	9.55	9.1	8.7	1152	33.2	0.76	83.7	6.5	2.1	2.1	57	0.0470
Y2-132M2-6	5.5	7.5	132M	12.8	12.1	11.7	1152	45.6	0.77	85.0	6.5	2.1	2.1	66	0.0580
Y2-160M-6	7.5	10	160M	17.2	16.3	15.8	1164	61.5	0.77	86.0	6.5	2.0	2.1	96	0.1160
Y2-160L-6	11	15	160L	24.1	22.9	22.0	1164	90.2	0.78	89.0	6.5	2.0	2.1	118	0.1510
Y2-180L-6	15	20	180L	31.4	29.9	28.8	1164	123.1	0.81	89.5	7.0	2.0	2.1	156	0.2670
Y2-200L1-6	18.5	25	200L	38.5	36.5	35.2	1170	151.0	0.81	90.2	7.0	2.1	2.1	193	0.4200
Y2-200L2-6	22	30	200L	44.3	42.0	40.5	1170	179.6	0.83	91.0	7.0	2.1	2.1	201	0.4640
Y2-225M-6	30	40	225M	59.2	56.2	54.2	1176	243.6	0.84	91.7	7.0	2.0	2.1	277	0.7250
Y2-250M-6	37	50	250M	71.3	67.7	65.3	1176	300.4	0.86	91.7	7.0	2.1	2.1	364	0.9500
Y2-280S-6	45	60	280S	86.7	82.4	79.4	1176	365.4	0.86	91.7	7.0	2.1	2.0	424	1.9200
Y2-280M-6	55	75	280M	106	100	96.6	1176	446.6	0.86	92.1	7.0	2.1	2.0	497	2.4000
Y2-315S-6	75	100	315S	142	135	130	1188	602.8	0.86	93.0	7.0	2.0	2.0	825	3.9400
Y2-315M-6	90	125	315M	171	162	157	1188	723.4	0.86	93.0	7.0	2.0	2.0	925	4.5800
Y2-315L1-6	110	150	315L	207	196	189	1188	884.2	0.86	94.1	6.7	2.0	2.0	1020	5.2300
Y2-315L2-6	132	180	315L	245	233	224	1188	1061.0	0.87	94.1	6.7	2.0	2.0	1100	5.5400
Y2-355M1-6	150	215	355M	275	261	252	1188	1205.7	0.88	94.1	6.7	1.9	2.0	1470	8.2750
Y2-355M2-6	200	270	355M	367	349	336	1188	1607.6	0.88	94.1	6.7	1.9	2.0	1600	10.0600
Y2-355L-6	250	340	355L	459	436	420	1188	2009.5	0.88	94.1	6.7	1.9	2.0	1800	13.1900

IE1 PERFORMANCE DATA:

8 Pole / 60Hz

Model	Rated Power		Frame size	Rated Current(A) (I _{FL})			Rated Speed RPM.	Rated Torque (T _{FL}) N.M	Power Factor (cosΦ)	Efficiency Full load %	Starting Current I _{ST} / I _{FL}	Starting Torque T _{ST} / T _{FL}	Maximum Torque T _M / T _{FL}	Weight (kg)	Moment of inertia (kgm ²)
	Kw	HP		At 380V	At 400V	At 415V									
Y2-801-8	0.18	0.24	80	1.12	1.06	1.03	774	2.2	0.61	40.0	3.3	1.8	1.9	16	0.0018
Y2-802-8	0.25	0.33	80	1.23	1.17	1.13	774	3.1	0.61	50.5	3.3	1.8	1.9	17	0.0021
Y2-90S-8	0.37	0.5	90S	1.63	1.55	1.49	804	4.4	0.60	57.5	4.0	1.8	1.9	24	0.0030
Y2-90L-8	0.55	0.75	90L	2.34	2.22	2.14	804	6.5	0.60	59.5	4.0	1.8	2.0	26	0.0040
Y2-100L1-8	0.75	1	100L	2.66	2.52	2.43	816	8.8	0.67	64.0	4.0	1.8	2.0	26	0.0063
Y2-100L2-8	1.1	1.5	100L	3.30	3.13	3.02	816	12.9	0.69	73.5	5.0	1.8	2.0	29	0.0097
Y2-112M-8	1.5	2	112M	4.29	4.08	3.93	840	17.1	0.69	77.0	5.0	1.8	2.0	36	0.0160
Y2-132S-8	2.2	3	132S	6.04	5.73	5.53	852	24.7	0.71	78.0	6.0	1.8	2.0	52	0.0370
Y2-132M-8	3	4	132M	7.90	7.51	7.24	852	33.6	0.73	79.0	6.0	1.8	2.0	57	0.0480
Y2-160M1-8	4	5.5	160M	10.4	9.9	9.5	864	44.2	0.73	80.0	6.0	1.9	2.0	84	0.0960
Y2-160M2-8	5.5	7.5	160M	13.4	12.8	12.3	864	60.8	0.74	84.0	6.0	2.0	2.0	96	0.1180
Y2-160L-8	7.5	10	160L	17.9	17.0	16.4	864	82.9	0.75	85.0	6.0	2.0	2.0	118	0.1510
Y2-180L-8	11	15	180L	25.1	23.9	23.0	876	119.9	0.76	87.5	6.6	2.0	2.0	156	0.2660
Y2-200L-8	15	20	200L	33.9	32.2	31.0	876	163.5	0.76	88.5	6.6	2.0	2.0	211	0.4460
Y2-225S-8	18.5	25	225S	41.8	39.7	38.3	876	201.7	0.76	88.5	6.6	1.9	2.0	256	0.6340
Y2-225M-8	22	30	225M	47.5	45.1	43.5	876	239.8	0.78	90.2	6.6	1.9	2.0	280	0.7750
Y2-250M-8	30	40	250M	64.0	60.8	58.6	876	327.0	0.79	90.2	6.6	1.9	2.0	392	0.8090
Y2-280S-8	37	50	280S	78.2	74.3	71.6	882	400.6	0.79	91.0	6.6	1.9	2.0	451	1.3810
Y2-280M-8	45	60	280M	95.1	90.4	87.1	882	487.2	0.79	91.0	6.6	1.9	2.0	511	1.7210
Y2-315S-8	55	75	315S	112.7522	107	103	882	595.5	0.81	91.5	6.6	1.8	2.0	810	4.5900
Y2-315M-8	75	100	315M	152.9174	145	140	882	812.0	0.81	92.0	6.6	1.8	2.0	970	5.3600
Y2-315L1-8	90	125	315L	180.2833	171	165	882	974.4	0.82	92.5	6.6	1.8	2.0	1070	6.1100
Y2-315L2-8	110	150	315L	220.3462	209	202	882	1190.9	0.82	92.5	6.4	1.8	2.0	1160	6.5500
Y2-355M1-8	132	180	355M	264	251	242	882	1429.1	0.82	92.5	6.4	1.8	2.0	1520	11.1400
Y2-355M2-8	160	215	355M	317	301	290	882	1732.2	0.83	92.5	6.4	1.8	2.0	1620	13.1200
Y2-355L-8	200	270	355L	396	376	362	882	2165.3	0.83	92.5	6.4	1.8	2.0	1800	16.0900

IE2 PERFORMANCE DATA:

2 Pole / 60Hz

Model	Rated Power		Frame size	Rated Current(A) (I _{FL})			Rated Speed RPM.	Rated Torque (T _{FL}) N.M	Power Factor (cosΦ)	Efficiency Full load %	Starting Current I _{ST} / I _{FL}	Starting Torque T _{ST} / T _{FL}	Maximum Torque T _M / T _{FL}	Weight (kg)	Moment of inertia (kgm ²)
	Kw	HP		At 380V	At 400V	At 415V									
YE2-711-2	0.37	0.5	71	0.96	0.92	0.88	3300	1.1	0.81	72.0	6.1	2.2	2.2	9	0.0004
YE2-712-2	0.55	0.75	71	1.38	1.31	1.26	3348	1.6	0.82	74.0	6.1	2.2	2.3	9.5	0.0006
YE2-801-2	0.75	1	80	1.82	1.73	1.67	3414	2.1	0.83	75.5	6.1	2.2	2.3	14.5	0.0010
YE2-802-2	1.1	1.5	80	2.41	2.29	2.21	3408	3.1	0.84	82.5	7.0	2.2	2.3	16	0.0011
YE2-90S-2	1.5	2	90S	3.23	3.07	2.96	3408	4.2	0.84	84.0	7.0	2.2	2.3	18.5	0.0023
YE2-90L-2	2.2	3	90L	4.60	4.37	4.21	3408	6.2	0.85	85.5	7.0	2.2	2.3	20.5	0.0030
YE2-100L-2	3	4	100L	5.91	5.62	5.41	3468	8.3	0.88	87.6	7.5	2.2	2.3	29	0.0060
YE2-112M-2	3.7	5.5	112M	7.29	6.93	6.68	3468	10.2	0.88	87.6	7.5	2.2	2.3	36	0.0075
YE2-132S1-2	5.5	7.5	132S	10.7	10.2	9.8	3492	15.0	0.88	88.5	7.5	2.2	2.3	48	0.0170
YE2-132S2-2	7.5	10	132S	14.5	13.7	13.2	3492	20.5	0.88	89.5	7.5	2.2	2.3	55	0.0180
YE2-160M1-2	11	15	160M	21.1	20.0	19.3	3522	29.8	0.88	90.2	7.5	2.2	2.3	96	0.0600
YE2-160M2-2	15	20	160M	28.7	27.3	26.3	3522	40.7	0.88	90.2	7.5	2.2	2.3	105	0.0670
YE2-160L-2	18.5	25	160L	34.7	33.0	31.8	3522	50.2	0.89	91.0	7.5	2.2	2.3	120	0.0780
YE2-180M-2	22	30	180M	41.3	39.2	37.8	3528	59.5	0.89	91.0	7.5	2.0	2.3	144	0.1180
YE2-200L1-2	30	40	200L	55.9	53.1	51.1	3534	81.1	0.89	91.7	7.5	2.0	2.3	207	0.2050
YE2-200L2-2	37	50	200L	68.4	64.9	62.6	3534	100.0	0.89	92.4	7.5	2.0	2.3	219	0.2300
YE2-225M-2	45	60	225M	82.6	78.5	75.6	3558	120.8	0.89	93.0	7.5	2.0	2.3	280	0.3100
YE2-250M-2	55	75	250M	101	95.9	92.4	3558	147.6	0.89	93.0	7.5	2.0	2.3	366	0.4920
YE2-280S-2	75	100	280S	137	130	125	3558	201.3	0.89	93.6	7.5	2.0	2.3	485	0.6950
YE2-280M-2	90	125	280M	159	151	146	3558	241.5	0.91	94.5	7.5	2.0	2.3	558	0.8520
YE2-315S-2	110	150	315S	194	185	178	3570	294.2	0.91	94.5	7.1	1.8	2.2	875	1.7530
YE2-315M-2	150	180	315M	264	250	241	3570	401.2	0.91	95.0	7.1	1.8	2.2	950	1.8740
YE2-315L1-2	185	215	315L	320	304	293	3570	494.8	0.92	95.4	7.1	1.8	2.2	1010	2.2960
YE2-315L2-2	200	270	315L	346	329	317	3570	535.0	0.92	95.4	7.1	1.8	2.2	1080	2.4780
YE2-355M-2	250	340	355M	438	416	401	3576	667.6	0.91	95.4	7.1	1.6	2.2	1550	3.3210
YE2-355L-2	315	430	355L	551	524	505	3576	841.1	0.91	95.4	7.2	1.6	2.2	1720	3.9850
YE2-355L-2	355	480	355L	621	590	569	3576	948.0	0.91	95.4	7.2	1.6	2.2	1800	4.6490

IE2 PERFORMANCE DATA:

4 Pole / 60Hz

Model	Rated Power		Frame size	Rated Current(A) (I _{FL})			Rated Speed RPM.	Rated Torque (T _{FL}) N.M	Power Factor (cosΦ)	Efficiency Full load %	Starting Current I _{ST} / I _{FL}	Starting Torque T _{ST} / T _{FL}	Maximum Torque T _M / T _{FL}	Weight (kg)	Moment of inertia (kgm ²)
	Kw	HP		At 380V	At 400V	At 415V									
YE2-711-4	0.25	0.33	71	0.73	0.70	0.67	1620	1.5	0.74	70.0	5.2	2.1	2.2	8.7	0.0007
YE2-712-4	0.37	0.5	71	1.04	0.99	0.95	1608	2.2	0.75	72.0	5.2	2.1	2.2	9.4	0.0008
YE2-801-4	0.55	0.75	80	1.48	1.40	1.35	1668	3.1	0.75	75.5	5.2	2.4	2.3	13.9	0.0016
YE2-802-4	0.75	1	80	1.92	1.83	1.76	1656	4.3	0.76	78.0	6.0	2.3	2.3	15.3	0.0019
YE2-90S-4	1.1	1.5	90S	2.62	2.49	2.40	1668	6.3	0.76	84.0	6.0	2.3	2.3	18.3	0.0029
YE2-90L-4	1.5	2	90L	3.48	3.30	3.19	1668	8.6	0.78	84.0	6.0	2.3	2.3	21.6	0.0034
YE2-100L1-4	2.2	3	100L	4.78	4.54	4.37	1692	12.4	0.80	87.5	7.0	2.3	2.3	28	0.0085
YE2-100L2-4	3	4	100L	6.51	6.19	5.96	1692	16.9	0.80	87.5	7.0	2.3	2.3	32	0.0133
YE2-112M-4	4	5.5	112M	8.46	8.04	7.75	1728	22.1	0.82	87.6	7.0	2.3	2.3	39	0.0140
YE2-132S-4	5.5	7.5	132S	11.4	10.8	10.4	1734	30.3	0.82	89.5	7.0	2.3	2.3	53	0.0320
YE2-132M-4	7.5	10	132M	15.2	14.4	13.9	1734	41.3	0.84	89.5	7.0	2.3	2.3	64	0.0400
YE2-160M-4	11	15	160M	21.9	20.8	20.0	1752	60.0	0.84	91.0	7.0	2.2	2.3	101	0.1010
YE2-160L-4	15	20	160L	29.8	28.3	27.3	1752	81.8	0.84	91.0	7.5	2.2	2.3	112	0.1270
YE2-180M-4	18.5	25	180M	35.4	33.6	32.4	1764	100.1	0.86	92.4	7.5	2.2	2.3	141	0.1700
YE2-180L-4	22	30	180L	42.1	40.0	38.5	1764	119.1	0.86	92.4	7.5	2.2	2.3	161	0.1900
YE2-200L-4	30	40	200L	57.0	54.1	52.2	1764	162.4	0.86	93.0	7.2	2.2	2.3	212	0.3300
YE2-225S-4	37	50	225S	69.5	66.0	63.6	1770	199.6	0.87	93.0	7.2	2.2	2.3	263	0.5600
YE2-225M-4	45	60	225M	84.0	79.8	76.9	1770	242.8	0.87	93.6	7.2	2.2	2.3	299	0.6500
YE2-250M-4	55	75	250M	102	97.0	93.5	1770	296.7	0.87	94.1	7.2	2.2	2.3	383	1.0500
YE2-280S-4	75	100	280S	139	132	127	1782	401.9	0.87	94.5	7.2	2.2	2.3	443	1.2980
YE2-280M-4	90	125	280M	166	158	152	1782	482.3	0.87	94.5	7.2	2.2	2.3	512	1.8100
YE2-315S-4	110	150	315S	200	190	183	1782	589.4	0.88	95.0	6.9	2.1	2.2	895	2.9800
YE2-315M-4	132	180	315M	240	228	220	1782	707.3	0.88	95.0	6.9	2.1	2.2	990	3.4800
YE2-315L1-4	160	215	315L	288	273	263	1782	857.4	0.89	95.0	6.9	2.1	2.2	1065	3.9600
YE2-315L2-4	200	270	315L	358	340	328	1782	1071.7	0.89	95.4	6.9	2.1	2.2	1155	4.4700
YE2-355M-4	250	340	355M	449	426	411	1788	1335.2	0.89	95.1	6.9	2.1	2.2	1650	7.8000
YE2-355L-4	315	430	355L	565	537	518	1788	1682.3	0.89	95.1	6.9	2.1	2.2	1760	9.6000
YE2-355L-4	355	480	355L	637	605	584	1788	1895.9	0.89	95.1	6.9	2.1	2.2	1890	11.0400

IE2 PERFORMANCE DATA:

6 Pole / 60Hz

Model	Rated Power		Frame size	Rated Current(A) (I _{FL})			Rated Speed RPM.	Rated Torque (T _{FL}) N.M	Power Factor (cosΦ)	Efficiency Full load %	Starting Current I _{ST} / I _{FL}	Starting Torque T _{ST} / T _{FL}	Maximum Torque T _M / T _{FL}	Weight (kg)	Moment of inertia (kgm ²)
	Kw	HP		At 380V	At 400V	At 415V									
YE2-711-6	0.18	0.24	71	0.75	0.72	0.69	1038	1.7	0.66	55.0	4.0	1.9	2.0	13	0.0011
YE2-712-6	0.25	0.33	71	0.94	0.89	0.86	1038	2.3	0.68	59.5	4.0	1.9	2.0	14	0.0012
YE2-801-6	0.37	0.5	80	1.25	1.19	1.15	1062	3.3	0.70	64.0	4.7	1.9	2.0	14.4	0.0024
YE2-802-6	0.55	0.75	80	1.71	1.62	1.56	1062	4.9	0.72	68.0	4.7	1.9	2.1	15.5	0.0026
YE2-90S-6	0.75	1	90S	2.17	2.06	1.99	1098	6.5	0.72	73.0	5.5	2.0	2.1	17.5	0.0040
YE2-90L-6	1.1	1.5	90L	2.68	2.54	2.45	1098	9.6	0.73	85.5	5.5	2.0	2.1	23	0.0056
YE2-100L-6	1.5	2	100L	3.51	3.34	3.22	1092	13.1	0.75	86.5	5.5	2.0	2.1	27	0.0100
YE2-112M-6	2.2	3	112M	5.03	4.78	4.60	1128	18.6	0.76	87.5	6.5	2.0	2.1	36	0.0160
YE2-132S-6	3	4	132S	6.85	6.5	6.3	1152	24.9	0.76	87.5	6.5	2.1	2.1	48	0.0370
YE2-132M1-6	3.7	5.5	132M	8.45	8.0	7.7	1152	30.7	0.76	87.5	6.5	2.1	2.1	57	0.0470
YE2-132M2-6	5.5	7.5	132M	12.1	11.5	11.1	1152	45.6	0.77	89.5	6.5	2.1	2.1	66	0.0580
YE2-160M-6	7.5	10	160M	16.5	15.7	15.1	1164	61.5	0.77	89.5	6.5	2.0	2.1	96	0.1160
YE2-160L-6	11	15	160L	23.8	22.6	21.8	1164	90.2	0.78	90.2	6.5	2.0	2.1	118	0.1510
YE2-180L-6	15	20	180L	31.2	29.6	28.6	1164	123.1	0.81	90.2	7.0	2.0	2.1	156	0.2670
YE2-200L1-6	18.5	25	200L	37.8	36.0	34.7	1170	151.0	0.81	91.7	7.0	2.1	2.1	193	0.4200
YE2-200L2-6	22	30	200L	43.9	41.7	40.2	1170	179.6	0.83	91.7	7.0	2.1	2.1	201	0.4640
YE2-225M-6	30	40	225M	58.3	55.4	53.4	1176	243.6	0.84	93.0	7.0	2.0	2.1	277	0.7250
YE2-250M-6	37	50	250M	70.3	66.8	64.4	1176	300.4	0.86	93.0	7.0	2.1	2.1	364	0.9500
YE2-280S-6	45	60	280S	84.9	80.7	77.8	1176	365.4	0.86	93.6	7.0	2.1	2.0	424	1.9200
YE2-280M-6	55	75	280M	104	99	95.1	1176	446.6	0.86	93.6	7.0	2.1	2.0	497	2.4000
YE2-315S-6	75	100	315S	141	134	129	1188	602.8	0.86	94.1	7.0	2.0	2.0	825	3.9400
YE2-315M-6	90	125	315M	169	161	155	1188	723.4	0.86	94.1	7.0	2.0	2.0	925	4.5800
YE2-315L1-6	110	150	315L	205	194	187	1188	884.2	0.86	95.0	6.7	2.0	2.0	1020	5.2300
YE2-315L2-6	132	180	315L	243	231	222	1188	1061.0	0.87	95.0	6.7	2.0	2.0	1100	5.5400
YE2-355M1-6	160	215	355M	291	276	266	1188	1286.1	0.88	95.0	6.7	1.9	2.0	1470	8.2750
YE2-355M2-6	200	270	355M	363	345	333	1188	1607.6	0.88	95.0	6.7	1.9	2.0	1600	10.0600
YE2-355L-6	250	340	355L	454	432	416	1188	2009.5	0.88	95.0	6.7	1.9	2.0	1800	13.1900

IE2 PERFORMANCE DATA:

8 Pole / 60Hz

Model	Rated Power		Frame size	Rated Current(A) (I _{FL})			Rated Speed RPM.	Rated Torque (T _{FL}) N.M	Power Factor (cosΦ)	Efficiency Full load %	Starting Current I _{ST} / I _{FL}	Starting Torque T _{ST} / T _{FL}	Maximum Torque T _M / T _{FL}	Weight (kg)	Moment of inertia (kgm ²)
	Kw	HP		At 380V	At 400V	At 415V									
YE2-801-8	0.18	0.24	80	0.97	0.93	0.89	774	2.2	0.61	46.0	3.3	1.8	1.9	16	0.0018
YE2-802-8	0.25	0.33	80	1.20	1.14	1.10	774	3.1	0.61	52.0	3.3	1.8	1.9	17	0.0021
YE2-90S-8	0.37	0.5	90S	1.62	1.53	1.48	804	4.4	0.60	58.0	4.0	1.8	1.9	24	0.0030
YE2-90L-8	0.55	0.75	90L	2.25	2.13	2.06	804	6.5	0.60	62.0	4.0	1.8	2.0	26	0.0040
YE2-100L1-8	0.75	1	100L	2.58	2.45	2.36	816	8.8	0.67	66.0	4.0	1.8	2.0	26	0.0063
YE2-100L2-8	1.1	1.5	100L	3.21	3.05	2.94	816	12.9	0.69	75.5	5.0	1.8	2.0	29	0.0097
YE2-112M-8	1.5	2	112M	4.00	3.80	3.67	840	17.1	0.69	82.5	5.0	1.8	2.0	36	0.0160
YE2-132S-8	2.2	3	132S	5.60	5.32	5.13	852	24.7	0.71	84.0	6.0	1.8	2.0	52	0.0370
YE2-132M-8	3	4	132M	7.30	6.94	6.69	710	40.3	0.73	85.5	6.0	1.8	2.0	57	0.0480
YE2-160M1-8	4	5.5	160M	9.7	9.3	8.9	864	44.2	0.73	85.5	6.0	1.9	2.0	96	0.0960
YE2-160M2-8	5.5	7.5	160M	13.2	12.5	12.1	864	60.8	0.74	85.5	6.0	2.0	2.0	118	0.1180
YE2-160L-8	7.5	10	160L	17.2	16.3	15.7	864	82.9	0.75	88.5	6.0	2.0	2.0	156	0.1510
YE2-180L-8	11	15	180L	24.8	23.6	22.8	876	119.9	0.76	88.5	6.6	2.0	2.0	211	0.2660
YE2-200L-8	15	20	200L	33.5	31.8	30.7	876	163.5	0.76	89.5	6.6	2.0	2.0	256	0.4460
YE2-225S-8	18.5	25	225S	41.3	39.3	37.8	876	201.7	0.76	89.5	6.6	1.9	2.0	280	0.6340
YE2-225M-8	22	30	225M	47.1	44.7	43.1	876	239.8	0.78	91.0	6.6	1.9	2.0	392	0.7750
YE2-250M-8	30	40	250M	63.4	60.2	58.1	876	327.0	0.79	91.0	6.6	1.9	2.0	451	0.8090
YE2-280S-8	37	50	280S	77.6	73.7	71.1	882	400.6	0.79	91.7	6.6	1.9	2.0	511	1.3810
YE2-280M-8	45	60	280M	94.4	89.7	86.4	882	487.2	0.79	91.7	6.6	1.9	2.0	810	1.7210
YE2-315S-8	55	75	315S	111	105	102	882	595.5	0.81	93.0	6.6	1.8	2.0	970	4.5900
YE2-315M-8	75	100	315M	151	144	139	882	812.0	0.81	93.0	6.6	1.8	2.0	1070	5.3600
YE2-315L1-8	90	125	315L	178	169	163	882	974.4	0.82	93.6	6.6	1.8	2.0	1160	6.1100
YE2-315L2-8	110	150	315L	218	207	199	882	1190.9	0.82	93.6	6.4	1.8	2.0	1520	6.5500
YE2-355M1-8	132	180	355M	264	251	242	882	1429.1	0.82	92.6	6.4	1.8	2.0	1620	11.1400
YE2-355M2-8	160	215	355M	315	299	288	882	1732.2	0.83	93.0	6.4	1.8	2.0	1800	13.1200
YE2-355L-8	200	270	355L	392	372	359	882	2165.3	0.83	93.5	6.4	1.8	2.0	1800	16.0900

IE3 PERFORMANCE DATA:

2 Pole / 60Hz

Model	Rated Power		Frame size	Rated Current(A) (I _{FL})			Rated Speed RPM.	Rated Torque (T _{FL}) N.M	Power Factor (cosΦ)	Efficiency Full load %	Starting Current I _{ST} / I _{FL}	Starting Torque T _{ST} / T _{FL}	Maximum Torque T _M / T _{FL}	Weight (kg)	Moment of inertia (kgm ²)
	Kw	HP		At 380V	At 400V	At 415V									
YE3-711-2	0.37	0.5	71	0.95	0.90	0.87	3300	1.1	0.81	73.4	6.1	2.2	2.2	9.2	0.0060
YE3-712-2	0.55	0.75	71	1.33	1.26	1.22	3348	1.6	0.82	76.8	6.1	2.2	2.3	9.5	0.0080
YE3-801-2	0.75	1	80	1.78	1.69	1.63	3414	2.1	0.83	77.0	7.0	2.2	2.3	17	0.0011
YE3-802-2	1.1	1.5	80	2.37	2.25	2.17	3414	3.1	0.84	84.0	7.4	2.2	2.3	18	0.0013
YE3-90S-2	1.5	2	90S	3.17	3.01	2.91	3426	4.2	0.84	85.5	7.0	2.2	2.3	23	0.0019
YE3-90L-2	2.2	3	90L	4.55	4.32	4.16	3432	6.1	0.85	86.5	7.0	2.2	2.3	26	0.0022
YE3-100L-2	3	4	100L	6.20	5.89	5.68	3432	8.3	0.85	86.5	7.0	2.2	2.3	34	0.0022
YE3-112M-2	3.7	5.5	112M	7.22	6.86	6.61	3450	10.2	0.88	88.5	7.5	2.2	2.5	41	0.0065
YE3-132S1-2	5.5	7.5	132S	10.6	10.1	9.72	3510	15.0	0.88	89.5	7.5	2.2	2.5	60	0.0146
YE3-132S2-2	7.5	10	132S	14.4	13.6	13.1	3510	20.4	0.88	90.2	7.5	2.2	2.5	63	0.0157
YE3-160M1-2	11	15	160M	20.9	19.8	19.1	3522	29.8	0.88	91.0	7.5	2.2	2.5	109	0.0549
YE3-160M2-2	15	20	160M	28.5	27.0	26.1	3522	40.7	0.88	91.0	7.5	2.2	2.5	119	0.0635
YE3-160L-2	18.5	25	160L	34.4	32.7	31.5	3528	50.1	0.89	91.7	7.5	2.2	2.2	136	0.0725
YE3-180M-2	22	30	180M	41.0	38.9	37.5	3540	59.3	0.89	91.7	7.5	2.0	2.2	172	0.1025
YE3-200L1-2	30	40	200L	55.4	52.7	50.8	3540	80.9	0.89	92.4	7.5	2.0	2.3	223	0.1730
YE3-200L2-2	37	50	200L	67.9	64.5	62.2	3540	99.8	0.89	93.0	7.5	2.0	2.3	242	0.1950
YE3-225M-2	45	60	225M	82.1	78.0	75.2	3558	120.8	0.89	93.6	7.5	2.0	2.3	302	0.3250
YE3-250M-2	55	75	250M	100.3	95.3	91.9	3564	147.4	0.89	93.6	7.5	2.0	2.3	382	0.3950
YE3-280S-2	75	100	280S	136	129	125	3570	200.6	0.89	94.1	7.5	2.0	2.3	515	0.6830
YE3-280M-2	90	125	280M	158	150	145	3576	240.3	0.91	95.0	7.5	2.0	2.3	545	0.7650
YE3-315S-2	110	150	315S	193	184	177	3570	294.2	0.91	95.0	7.1	1.8	2.2	930	1.5580
YE3-315M-2	132	180	315M	231	219	212	3570	353.1	0.91	95.4	7.1	1.8	2.2	980	1.7260
YE3-315L1-2	160	215	315L	276	263	253	3576	427.2	0.92	95.6	7.1	1.8	2.2	1090	1.9410
YE3-315L2-2	200	270	315L	345	328	316	3576	534.1	0.92	95.8	7.1	1.8	2.2	1190	2.2120
YE3-355M-2	250	340	355M	431	409	395	3576	667.6	0.92	95.8	7.5	1.8	2.2	1550	4.0300
YE3-355L-2	315	430	355L	543	516	497	3576	841.1	0.92	95.8	7.5	1.8	2.2	1720	4.6100

IE3 PERFORMANCE DATA:

4 Pole / 60Hz

Model	Rated Power		Frame size	Rated Current(A) (I _{FL})			Rated Speed RPM.	Rated Torque (T _{FL}) N.M	Power Factor (cosΦ)	Efficiency Full load %	Starting Current I _{ST} / I _{FL}	Starting Torque T _{ST} / T _{FL}	Maximum Torque T _M / T _{FL}	Weight (kg)	Moment of inertia (kgm ²)
	Kw	HP		At 380V	At 400V	At 415V									
YE3-711-4	0.25	0.33	71	0.70	0.66	0.64	1620	1.5	0.74	73.4	5.2	2.1	2.2	9	0.0008
YE3-712-4	0.37	0.5	71	0.96	0.91	0.88	1608	2.2	0.75	78.2	5.2	2.1	2.2	10	0.0012
YE3-801-4	0.55	0.75	80	1.37	1.31	1.26	1668	3.1	0.75	81.1	5.2	2.3	2.3	14.5	0.0014
YE3-802-4	0.75	1	80	1.80	1.71	1.64	1692	4.2	0.76	83.5	6.5	2.3	2.3	19	0.0017
YE3-90S-4	1.1	1.5	90S	2.54	2.42	2.33	1704	6.2	0.76	86.5	6.0	2.3	2.5	23	0.0023
YE3-90L-4	1.5	2	90L	3.38	3.21	3.09	1704	8.4	0.78	86.5	6.0	2.3	2.5	29	0.0031
YE3-100L1-4	2.2	3	100L	4.67	4.44	4.27	1728	12.2	0.80	89.5	7.0	2.3	2.3	35	0.0078
YE3-100L1-4	3	4	100L	6.37	6.05	5.83	1728	16.6	0.80	89.5	7.0	2.3	2.3	39	0.0078
YE3-112M-4	3.7	5.5	112M	7.66	7.28	7.01	1734	20.4	0.82	89.5	7.0	2.3	2.5	45	0.0185
YE3-112M-4	4	5.5	112M	8.28	7.87	7.58	1734	22.0	0.82	89.5	7.0	2.3	2.5	45	0.0185
YE3-132S-4	5.5	7.5	132S	11.1	10.6	10.2	1746	30.1	0.82	91.7	7.0	2.3	2.5	62	0.0330
YE3-132M-4	7.5	10	132M	14.8	14.1	13.5	1752	40.9	0.84	91.7	7.0	2.3	2.5	74	0.0412
YE3-160M-4	11	15	160M	21.5	20.5	19.7	1752	60.0	0.84	92.4	7.0	2.2	2.5	115	0.1052
YE3-160L-4	15	20	162L	29.2	27.7	26.7	1752	81.8	0.84	93.0	7.5	2.2	2.5	135	0.1123
YE3-180M-4	18.5	25	180M	34.9	33.2	32.0	1764	100.1	0.86	93.6	7.5	2.2	2.5	170	0.1695
YE3-180L-4	22	30	180L	41.5	39.4	38.0	1764	119.1	0.86	93.6	7.5	2.2	2.5	184	0.1865
YE3-200L-4	30	40	200L	56.3	53.5	51.6	1764	162.4	0.86	94.1	7.2	2.2	2.5	235	0.3020
YE3-225S-4	37	50	225S	68.4	65.0	62.6	1776	198.9	0.87	94.5	7.2	2.2	2.5	290	0.5380
YE3-225M-4	45	60	225M	82.7	78.6	75.7	1776	242.0	0.87	95.0	7.2	2.2	2.3	326	0.6350
YE3-250M-4	55	75	250M	100.7	95.7	92.2	1776	295.7	0.87	95.4	7.2	2.2	2.5	385	0.7850
YE3-280S-4	75	100	280S	137	130	126	1782	401.9	0.87	95.4	7.2	2.2	2.5	515	1.5520
YE3-280M-4	90	125	280M	165	157	151	1782	482.3	0.87	95.4	7.2	2.2	2.5	605	1.8650
YE3-315S-4	110	150	315S	198	188	182	1782	589.4	0.88	95.8	6.9	2.1	2.2	931	3.4800
YE3-315M-4	132	180	315M	237	225	217	1782	707.3	0.88	96.2	6.9	2.1	2.2	1017	3.6780
YE3-315L1-4	185	215	315L	328	312	301	1782	991.3	0.89	96.2	6.9	2.1	2.2	1085	4.4720
YE3-315L2-4	200	270	315L	355	337	325	1782	1071.7	0.89	96.2	6.9	2.1	2.2	1200	4.8560
YE3-355M-4	250	340	355M	439	417	402	1788	1335.2	0.90	96.2	7.1	2.0	2.2	1650	6.1920
YE3-355L1-4	315	430	355L	553	525	506	1788	1682.3	0.90	96.2	7.1	2.0	2.2	1760	7.2730
YE3-355L2-4	355	430	355L	623	592	570	1788	1895.9	0.90	96.2	7.1	2.0	2.2	1890	8.1960

IE3 PERFORMANCE DATA:

6 Pole / 60Hz

Model	Rated Power		Frame size	Rated Current(A) (I _{FL})			Rated Speed RPM.	Rated Torque (T _{FL}) N.M	Power Factor (cosΦ)	Efficiency Full load %	Starting Current I _{ST} / I _{FL}	Starting Torque T _{ST} / T _{FL}	Maximum Torque T _M / T _{FL}	Weight (kg)	Moment of inertia (kgm ²)
	Kw	HP		At 380V	At 400V	At 415V									
YE3-711-6	0.18	0.24	71	0.61	0.58	0.56	1038	1.7	0.66	67.5	4.0	1.9	2.0	13	0.0080
YE3-712-6	0.25	0.33	71	0.78	0.74	0.72	1038	2.3	0.68	71.4	4.0	1.9	2.0	14	0.0090
YE3-801-6	0.37	0.5	80	1.07	1.01	0.98	1062	3.3	0.70	75.3	4.7	1.9	2.0	14.4	0.0024
YE3-802-6	0.55	0.75	80	1.42	1.35	1.30	1062	4.9	0.72	81.7	4.7	1.9	2.1	15.5	0.0026
YE3-90S-6	0.75	1	90S	1.92	1.82	1.76	1110	6.5	0.72	82.5	5.5	2.0	2.3	24	0.0032
YE3-90L-6	1.1	1.5	90L	2.62	2.49	2.40	1104	9.5	0.73	87.5	5.5	2.0	2.3	26	0.0041
YE3-100L-6	1.5	2	100L	3.43	3.26	3.14	1116	12.8	0.75	88.5	5.5	2.0	2.2	34	0.0085
YE3-112M-6	2.2	3	112M	4.91	4.67	4.50	1134	18.5	0.76	89.5	6.5	2.0	2.2	40	0.0133
YE3-132S-6	3	4	132S	6.7	6.37	6.14	1158	24.7	0.76	89.5	6.5	2.1	2.5	54	0.0489
YE3-132M1-6	3.7	5.5	132M	8.3	7.85	7.57	1158	30.5	0.76	89.5	6.5	2.1	2.5	73	0.0489
YE3-132M2-6	5.5	7.5	132M	11.9	11.3	10.9	1158	45.4	0.77	91.0	6.5	2.1	2.5	77	0.0585
YE3-160M-6	7.5	10	160M	16.3	15.4	14.9	1164	61.5	0.77	91.0	6.5	2.0	2.3	110	0.1212
YE3-160L-6	11	15	160L	23.4	22.2	21.4	1164	90.2	0.78	91.7	6.4	2.0	2.3	133	0.1452
YE3-180L-6	15	20	180L	30.7	29.1	28.1	1170	122.4	0.81	91.7	7.0	2.0	2.3	174	0.2285
YE3-200L1-6	18.5	25	200L	37.3	35.4	34.2	1176	150.2	0.81	93.0	7.0	2.1	2.4	219	0.3420
YE3-200L2-6	22	30	200L	43.3	41.1	39.7	1176	178.6	0.83	93.0	7.0	2.1	2.4	228	0.3860
YE3-225M-6	30	40	225M	57.7	54.8	52.8	1176	243.6	0.84	94.1	7.0	2.0	2.3	296	0.6250
YE3-250M-6	37	50	250M	69.5	66.0	63.6	1176	300.4	0.86	94.1	7.0	2.1	2.5	380	0.9850
YE3-280S-6	45	60	280S	84.1	79.9	77.0	1182	363.5	0.86	94.5	7.0	2.1	2.5	470	1.7325
YE3-280M-6	55	75	280M	103	97.7	94	1182	444.3	0.86	94.5	7.0	2.1	2.5	545	1.9650
YE3-315S-6	75	100	315S	139	133	128	1188	602.8	0.86	95.0	7.0	2.0	2.2	866	3.7230
YE3-315M-6	90	125	315M	167	159	153	1188	723.4	0.86	95.0	7.0	2.0	2.2	948	4.5260
YE3-315L1-6	110	150	315L	203	193	186	1188	884.2	0.86	95.8	6.7	2.0	2.2	1120	5.1570
YE3-315L2-6	132	180	315L	241	229	220	1188	1061.0	0.87	95.8	6.7	2.0	2.2	1185	5.6850
YE3-355M1-6	160	215	355M	292	277	267	1188	1286.1	0.87	95.8	6.8	1.8	2.0	1470	10.2220
YE3-355M2-6	200	270	355M	365	346	334	1188	1607.6	0.87	95.8	6.8	1.8	2.0	1600	11.0310
YE3-355L-6	250	340	355L	456	433	417	1188	2009.5	0.87	95.8	6.8	1.8	2.0	1800	11.8970

IE3 PERFORMANCE DATA:

8 Pole / 60Hz

Model	Rated Power		Frame size	Rated Current(A) (I _{FL})			Rated Speed RPM.	Rated Torque (T _{FL}) N.M	Power Factor (cosΦ)	Efficiency Full load %	Starting Current I _{ST} / I _{FL}	Starting Torque T _{ST} / T _{FL}	Maximum Torque T _M / T _{FL}	Weight (kg)	Moment of inertia (kgm ²)
	Kw	HP		At 380V	At 400V	At 415V									
YE3-801-8	0.18	0.24	80	0.70	0.67	0.64	774	2.2	0.61	64.0	3.3	1.8	1.9	16	0.0022
YE3-802-8	0.25	0.33	80	0.92	0.87	0.84	774	3.1	0.61	68.0	3.3	1.8	1.9	17	0.0025
YE3-90S-8	0.37	0.5	90S	1.30	1.24	1.19	804	4.4	0.60	72.0	4.0	1.8	1.9	24	0.0038
YE3-90L-8	0.55	0.75	90L	1.88	1.79	1.72	804	6.5	0.60	74.0	4.0	1.8	2.0	26	0.0058
YE3-100L1-8	0.75	1	100L	2.25	2.14	2.06	816	8.8	0.67	75.5	4.0	1.8	2.0	33	0.0158
YE3-100L2-8	1.1	1.5	100L	3.09	2.93	2.83	816	12.9	0.69	78.5	5.0	1.8	2.0	34	0.0223
YE3-112M-8	1.5	2	112M	3.93	3.74	3.60	840	17.1	0.69	84.0	5.0	1.8	2.0	38.5	0.0387
YE3-132S-8	2.2	3	132S	5.51	5.23	5.04	852	24.7	0.71	85.5	6.0	1.8	2.0	54	0.0346
YE3-132M-8	3	4	132M	7.51	7.13	6.88	852	33.6	0.71	85.5	6.0	1.8	2.0	73	0.0428
YE3-160M1-8	3.7	5.5	160M	8.9	8.5	8.2	864	40.9	0.73	86.5	6.0	1.9	2.0	86.2	0.0557
YE3-160M2-8	5.5	7.5	160M	13.1	12.4	12.0	864	60.8	0.74	86.5	6.0	2.0	2.0	98.5	0.1380
YE3-160L-8	7.5	10	160L	17.0	16.1	15.5	864	82.9	0.75	89.5	6.0	2.0	2.0	120	0.1910
YE3-180L-8	11	15	180L	24.6	23.3	22.5	876	119.9	0.76	89.5	6.6	2.0	2.0	160	0.3160
YE3-200L-8	15	20	200L	33.2	31.6	30.4	876	163.5	0.76	90.2	6.6	2.0	2.0	211	0.4420
YE3-225S-8	18.5	25	225S	41.0	39.0	37.5	876	201.7	0.76	90.2	6.6	1.9	2.0	270	0.5550
YE3-225M-8	22	30	225M	46.7	44.4	42.8	876	239.8	0.78	91.7	6.6	1.9	2.0	295	0.8310
YE3-250M-8	30	40	250M	62.9	59.8	57.6	876	327.0	0.79	91.7	6.6	1.9	2.0	370	1.4450
YE3-280S-8	37	50	280S	77.0	73.2	70.5	882	400.6	0.79	92.4	6.6	1.9	2.0	475	2.2510
YE3-280M-8	45	60	280M	93.7	89.0	85.8	882	487.2	0.79	92.4	6.6	1.9	2.0	555	2.7160
YE3-315S-8	55	75	315S	110	105	101	882	595.5	0.81	93.6	6.6	1.8	2.0	905	3.9770
YE3-315M-8	75	100	315M	150	143	138	882	812.0	0.81	93.6	6.6	1.8	2.0	981	4.4500
YE3-315L1-8	90	125	315L	177	168	162	882	974.4	0.82	94.1	6.6	1.8	2.0	1070	5.5570
YE3-315L2-8	110	150	315L	217	206	198	882	1190.9	0.82	94.1	6.4	1.8	2.0	1160	6.9280
YE3-355M1-8	132	180	355M	260	247	238	882	1429.1	0.82	94.1	6.1	1.8	2.0	1520	10.1330
YE3-355M2-8	160	215	355M	310	294	284	882	1732.2	0.83	94.5	6.1	1.8	2.0	1620	10.9830
YE3-355L-8	200	270	355L	385	366	353	882	2165.3	0.83	95.0	6.4	1.8	2.0	1800	11.5630

IE4 PERFORMANCE DATA:

2 Pole / 60Hz

Model	Rated Power		Frame size	Rated Current(A) (I _{FL})			Rated Speed RPM.	Rated Torque (T _{FL}) N.M	Power Factor (cosΦ)	Efficiency Full load %	Starting Current I _{ST} / I _{FL}	Starting Torque T _{ST} / T _{FL}	Maximum Torque T _M / T _{FL}	Weight (kg)	Moment of inertia (kgm ²)
	Kw	HP		At 380V	At 400V	At 415V									
YE4-801-2	0.37	0.5	80	0.91	0.87	0.84	3300	1.1	0.80	77.0	6.1	2.2	2.2	16	0.0001
YE4-802-2	0.55	0.75	80	1.31	1.24	1.20	3348	1.6	0.80	80.0	6.1	2.2	2.3	17	0.0005
YE4-801-2	0.75	1	80	1.68	1.60	1.54	3462	2.1	0.82	82.5	8.5	2.2	2.3	16.5	0.0011
YE4-802-2	1.1	1.5	80	2.36	2.24	2.16	3468	3.0	0.83	85.5	8.5	2.2	2.3	18.5	0.0013
YE4-90S-2	1.5	2	90S	3.14	2.98	2.87	3492	4.1	0.84	86.5	9.0	2.2	2.3	25	0.0019
YE4-90L-2	2.2	3	90L	4.44	4.22	4.07	3492	6.0	0.85	88.5	9.0	2.2	2.3	26	0.0022
YE4-100L-2	3	4	100L	5.89	5.59	5.39	3504	8.2	0.87	89.0	9.5	2.2	2.5	34	0.0043
YE4-112M-2	4	5.5	112M	7.72	7.33	7.07	3504	10.9	0.88	89.5	9.5	2.2	2.5	43	0.0065
YE4-132S1-2	5.5	7.5	132S	10.5	10.0	9.64	3510	15.0	0.88	90.2	9.5	2.2	2.5	62	0.0146
YE4-132S2-2	7.5	10	132S	14.1	13.4	12.9	3510	20.4	0.88	91.7	9.5	2.2	2.5	74	0.0157
YE4-160M1-2	11	15	160M	20.3	19.3	18.6	3522	29.8	0.89	92.4	9.5	2.2	2.5	105	0.0549
YE4-160M2-2	15	20	160M	27.7	26.3	25.4	3522	40.7	0.89	92.4	9.5	2.2	2.5	116	0.0635
YE4-160L-2	18.5	25	160L	34.0	32.3	31.1	3528	50.1	0.89	93.0	9.5	2.2	2.2	135	0.0725
YE4-180M-2	22	30	180M	40.4	38.4	37.0	3540	59.3	0.89	93.0	9.5	2.0	2.2	195	0.1025
YE4-200L1-2	30	40	200L	54.7	52.0	50.1	3540	80.9	0.89	93.6	9.0	2.0	2.3	249	0.1730
YE4-200L2-2	37	50	200L	67.1	63.8	61.5	3540	99.8	0.89	94.1	9.0	2.0	2.3	258	0.1950
YE4-225M-2	45	60	225M	80.4	76.4	73.6	3558	120.8	0.90	94.5	9.0	2.0	2.3	310	0.3250
YE4-250M-2	55	75	250M	98.3	93.3	90.0	3564	147.4	0.90	94.5	9.0	2.0	2.3	386	0.3950
YE4-280S-2	75	100	280S	133	127	122	3570	200.6	0.90	95.0	8.5	2.0	2.3	544	0.6830
YE4-280M-2	90	125	280M	159	151	146	3570	240.7	0.90	95.4	8.5	2.0	2.3	606	0.7650
YE4-315S-2	110	150	315S	195	185	178	3570	294.2	0.90	95.4	8.5	1.8	2.2	930	1.5580
YE4-315M-2	132	180	315M	233	221	213	3570	353.1	0.90	95.6	8.5	1.8	2.2	980	1.7260
YE4-315L1-2	160	215	315L	279	265	255	3576	427.2	0.91	95.8	8.5	1.8	2.2	1090	1.9410
YE4-315L2-2	200	270	315L	347	330	318	3576	534.1	0.91	96.2	8.5	1.8	2.2	1190	2.2120
YE4-355M-2	250	340	355M	434	412	397	3576	667.6	0.91	96.2	8.5	1.6	2.2	1802	4.0300
YE4-355L-2	315	430	355L	547	519	501	3576	841.1	0.91	96.2	8.5	1.6	2.2	2017	4.6100

IE4 PERFORMANCE DATA:

4 Pole / 60Hz

Model	Rated Power		Frame size	Rated Current(A) (I _{FL})			Rated Speed RPM.	Rated Torque (T _{FL}) N.M	Power Factor (cosΦ)	Efficiency Full load %	Starting Current I _{ST} / I _{FL}	Starting Torque T _{ST} / T _{FL}	Maximum Torque T _M / T _{FL}	Weight (kg)	Moment of inertia (kgm ²)
	Kw	HP		At 380V	At 400V	At 415V									
YE4-801-4	0.25	0.33	80	0.68	0.64	0.62	1620	1.5	0.73	77.0	5.2	2.1	2.2	14	0.0016
YE4-801-4	0.37	0.5	80	0.94	0.90	0.87	1620	2.2	0.73	81.5	5.2	2.1	2.2	15	0.0017
YE4-801-4	0.55	0.75	80	1.33	1.26	1.21	1692	3.1	0.75	84.0	6.5	2.3	2.3	16.7	0.0017
YE4-802-4	0.75	1	80	1.78	1.69	1.63	1692	4.2	0.75	85.5	8.5	2.3	2.3	19.5	0.0017
YE4-90S-4	1.1	1.5	90S	2.51	2.39	2.30	1704	6.2	0.76	87.5	8.5	2.3	2.5	25.9	0.0023
YE4-90L-4	1.5	2	90L	3.34	3.18	3.06	1704	8.4	0.77	88.5	9.0	2.3	2.5	29.3	0.0031
YE4-100L1-4	2.2	3	100L	4.53	4.31	4.15	1728	12.2	0.81	91.0	9.0	2.3	2.3	33.8	0.0078
YE4-100L2-4	3	4	100L	6.11	5.80	5.59	1728	16.6	0.82	91.0	9.5	2.3	2.5	39.5	0.0087
YE4-112M-4	4	5.5	112M	8.14	7.74	7.46	1734	22.0	0.82	91.0	9.5	2.3	2.5	47.5	0.0185
YE4-132S-4	5.5	7.5	132S	10.9	10.4	10.0	1746	30.1	0.83	92.4	9.5	2.3	2.5	70	0.0330
YE4-132M-4	7.5	10	132M	14.7	13.9	13.4	1752	40.9	0.84	92.4	9.5	2.3	2.5	85	0.0412
YE4-160M-4	11	15	160M	21.0	20.0	19.2	1752	60.0	0.85	93.6	9.5	2.2	2.5	118	0.1052
YE4-160L-4	15	20	160L	28.2	26.8	25.8	1752	81.8	0.86	94.1	9.5	2.2	2.5	137	0.1123
YE4-180M-4	18.5	25	180M	34.6	32.9	31.7	1764	100.1	0.86	94.5	9.5	2.2	2.5	164	0.1695
YE4-180L-4	22	30	180L	41.1	39.1	37.7	1764	119.1	0.86	94.5	9.5	2.2	2.5	193	0.1865
YE4-200L-4	30	40	200L	55.8	53.0	51.1	1764	162.4	0.86	95.0	9.0	2.2	2.5	249	0.3020
YE4-225S-4	37	50	225L	68.5	65.1	62.7	1776	198.9	0.86	95.4	9.0	2.2	2.5	300	0.5380
YE4-225M-4	45	60	225M	83.3	79.2	76.3	1776	242.0	0.86	95.4	9.0	2.2	2.3	343	0.6350
YE4-250M-4	55	75	250M	101.4	96.4	92.9	1776	295.7	0.86	95.8	9.0	2.2	2.5	443	0.7850
YE4-280S-4	75	100	280S	135	128	123	1782	401.9	0.88	96.2	8.5	2.2	2.5	461	1.5520
YE4-280M-4	90	125	280M	162	153	148	1782	482.3	0.88	96.2	8.5	2.2	2.5	572	1.8650
YE4-315S-4	110	150	315S	195	185	179	1782	589.4	0.89	96.2	8.5	2.1	2.2	931	3.4800
YE4-315M-4	132	180	315M	234	222	214	1782	707.3	0.89	96.3	8.5	2.1	2.2	1017	3.6780
YE4-315L1-4	160	215	315L	283	269	259	1782	857.4	0.89	96.5	8.5	2.1	2.2	1085	4.4720
YE4-315L2-4	200	270	315L	350	332	320	1782	1071.7	0.90	96.6	8.5	2.1	2.2	1200	4.8560
YE4-355M-4	250	340	355M	436	414	399	1788	1335.2	0.90	96.8	8.5	2.1	2.2	1815	6.1920
YE4-355L-4	315	430	355L	549	522	503	1788	1682.3	0.90	96.8	8.5	2.1	2.2	1984	7.2730

IE4 PERFORMANCE DATA:

6 Pole / 60Hz

Model	Rated Power		Frame size	Rated Current(A) (I _{FL})			Rated Speed RPM.	Rated Torque (T _{FL}) N.M	Power Factor (cosΦ)	Efficiency Full load %	Starting Current I _{ST} / I _{FL}	Starting Torque T _{ST} / T _{FL}	Maximum Torque T _M / T _{FL}	Weight (kg)	Moment of inertia (kgm ²)
	Kw	HP		At 380V	At 400V	At 415V									
YE4-801A-6	0.18	0.24	80	0.58	0.55	0.53	1038	1.7	0.66	72.0	4.0	1.9	2.0	9	0.0080
YE4-802A-6	0.25	0.33	80	0.74	0.70	0.68	1038	2.3	0.68	75.5	4.0	1.9	2.0	10	0.0090
YE4-801-6	0.37	0.5	80	1.02	0.97	0.94	1062	3.3	0.70	78.5	4.7	1.9	2.0	17	0.0024
YE4-802-6	0.55	0.75	80	1.45	1.37	1.32	1062	4.9	0.70	82.5	4.7	1.9	2.1	19	0.0026
YE4-90S-6	0.75	1	90S	1.91	1.82	1.75	1104	6.5	0.71	84.0	7.5	2.0	2.3	22.5	0.0032
YE4-90L-6	1.1	1.5	90L	2.59	2.46	2.37	1104	9.5	0.73	88.5	7.5	2.0	2.3	25.5	0.0041
YE4-100L-6	1.5	2	100L	3.49	3.31	3.19	1116	12.8	0.73	89.5	7.5	2.0	2.2	33	0.0085
YE4-112M-6	2.2	3	112M	5.01	4.76	4.59	1134	18.5	0.74	90.2	7.5	2.0	2.2	40	0.0133
YE4-132S-6	3	4	132S	6.83	6.49	6.25	1158	24.7	0.74	90.2	7.5	2.1	2.5	50	0.0372
YE4-132M1-6	4	5.5	132M	9.1	8.65	8.34	1158	33.0	0.74	90.2	8.0	2.1	2.5	66	0.0489
YE4-132M2-6	5.5	7.5	132M	12.2	11.5	11.1	1158	45.4	0.75	91.7	8.0	2.1	2.5	74	0.0585
YE4-160M-6	7.5	10	160M	15.6	14.8	14.3	1164	61.5	0.79	92.4	8.0	2.0	2.3	113	0.1212
YE4-160L-6	11	15	160L	22.5	21.3	20.6	1164	90.2	0.80	93.0	8.5	2.0	2.3	134	0.1452
YE4-180L-6	15	20	180L	30.3	28.7	27.7	1170	122.4	0.81	93.0	8.5	2.0	2.3	181	0.2285
YE4-200L1-6	18.5	25	200L	36.9	35.0	33.8	1176	150.2	0.81	94.1	8.5	2.1	2.4	216	0.3420
YE4-200L2-6	22	30	200L	43.9	41.7	40.2	1176	178.6	0.81	94.1	8.5	2.1	2.4	241	0.3860
YE4-225M-6	30	40	225M	57.8	54.9	52.9	1176	243.6	0.83	95.0	8.3	2.0	2.3	290	0.6250
YE4-250M-6	37	50	250M	70.4	66.9	64.5	1176	300.4	0.84	95.0	8.3	2.1	2.5	450	0.9850
YE4-280S-6	45	60	280S	84.3	80.1	77.2	1182	363.5	0.85	95.4	8.5	2.1	2.5	481	1.7325
YE4-280M-6	55	75	280M	102	96.8	93	1182	444.3	0.86	95.4	8.5	2.1	2.5	566	1.9650
YE4-315S-6	75	100	315S	142	135	130	1182	605.9	0.84	95.8	8.0	2.0	2.2	866	3.7230
YE4-315M-6	90	125	315M	168	160	154	1182	727.1	0.85	95.8	8.0	2.0	2.2	948	4.5260
YE4-315L1-6	110	150	315L	204	194	187	1182	888.7	0.85	96.2	8.0	2.0	2.2	1120	5.1570
YE4-315L2-6	132	180	315L	242	230	222	1182	1066.4	0.86	96.2	8.0	2.0	2.2	1185	5.6850
YE4-355M1-6	160	215	355M	294	279	269	1188	1286.1	0.86	96.2	8.0	1.9	2.0	1709	10.2220
YE4-355M2-6	200	270	355M	366	348	335	1188	1607.6	0.86	96.5	8.0	1.9	2.0	1945	11.0310
YE4-355L-6	250	340	355L	458	435	419	1188	2009.5	0.86	96.5	8.0	1.9	2.0	2092	11.8970

IE4 PERFORMANCE DATA:

8 Pole / 60Hz

Model	Rated Power		Frame size	Rated Current(A) (I _{FL})			Rated Speed RPM.	Rated Torque (T _{FL}) N.M	Power Factor (cosΦ)	Efficiency Full load %	Starting Current I _{ST} / I _{FL}	Starting Torque T _{ST} / T _{FL}	Maximum Torque T _M / T _{FL}	Weight (kg)	Moment of inertia (kgm ²)
	Kw	HP		At 380V	At 400V	At 415V									
YE4-801-8	0.18	0.24	80	0.66	0.63	0.60	774	2.2	0.61	68.0	3.3	1.8	1.9	17	0.0043
YE4-802-8	0.25	0.33	80	0.86	0.82	0.79	774	3.1	0.61	72.0	3.3	1.8	1.9	18	0.0047
YE4-90S-8	0.37	0.5	90S	1.24	1.18	1.14	804	4.4	0.60	75.5	4.0	1.8	1.9	25	0.0085
YE4-90L-8	0.55	0.75	90L	1.81	1.72	1.66	804	6.5	0.60	77.0	4.0	1.8	2.0	27	0.0113
YE4-100L1-8	0.75	1	100L	2.20	2.09	2.01	816	8.8	0.66	78.5	7.0	1.8	2.0	35	0.0152
YE4-100L2-8	1.1	1.5	100L	3.06	2.91	2.80	816	12.9	0.67	81.5	7.0	1.8	2.0	36	0.0210
YE4-112M-8	1.5	2	112M	3.86	3.67	3.54	840	17.1	0.69	85.5	7.0	1.8	2.0	40	0.0249
YE4-132S-8	2.2	3	132S	5.46	5.18	5.00	852	24.7	0.70	87.5	7.5	1.8	2.0	57	0.0533
YE4-132M-8	3	4	132M	7.40	7.03	6.78	852	33.6	0.70	88.0	7.8	1.8	2.0	62	0.0593
YE4-160M1-8	4	5.5	160M	9.7	9.2	8.9	864	44.2	0.71	88.5	7.9	1.9	2.0	91	0.0919
YE4-160M2-8	5.5	7.5	160M	13.1	12.5	12.0	864	60.8	0.72	88.5	8.1	2.0	2.0	103	0.1178
YE4-160L-8	7.5	10	160L	16.9	16.1	15.5	864	82.9	0.74	91.0	7.8	2.0	2.0	126	0.1510
YE4-180L-8	11	15	180L	24.8	23.6	22.7	876	119.9	0.74	91.0	7.9	2.0	2.0	168	0.2660
YE4-200L-8	15	20	200L	33.1	31.5	30.3	876	163.5	0.75	91.7	8.0	2.0	2.0	222	0.4460
YE4-225S-8	18.5	25	225S	40.9	38.8	37.4	876	201.7	0.75	91.7	8.1	1.9	2.0	284	0.6340
YE4-225M-8	22	30	225M	47.3	44.9	43.3	876	239.8	0.76	93.0	8.3	1.9	2.0	310	0.7750
YE4-250M-8	30	40	250M	63.7	60.5	58.3	876	327.0	0.77	93.0	7.9	1.9	2.0	389	0.8090
YE4-280S-8	37	50	280S	77.0	73.2	70.5	882	400.6	0.78	93.6	7.9	1.9	2.0	499	1.3810
YE4-280M-8	45	60	280M	93.7	89.0	85.8	882	487.2	0.78	93.6	7.9	1.9	2.0	583	1.7210
YE4-315S-8	55	75	315S	111	105	101	882	595.5	0.80	94.5	8.2	1.8	2.0	950	4.5900
YE4-315M-8	75	100	315M	151	143	138	882	812.0	0.80	94.5	7.6	1.8	2.0	1030	5.3600
YE4-315L1-8	90	125	315L	178	169	163	882	974.4	0.81	95.0	7.7	1.8	2.0	1124	6.1100
YE4-315L2-8	110	150	315L	217	206	199	882	1190.9	0.81	95.0	7.7	1.8	2.0	1218	6.5500
YE4-355M1-8	132	180	355M	260	247	238	882	1429.1	0.81	95.2	7.7	1.8	2.0	1800	15.0732
YE4-355M2-8	160	215	355M	311	295	285	882	1732.2	0.82	95.4	7.7	1.8	2.0	1890	16.2670
YE4-355L-8	200	270	355L	388	369	356	882	2165.3	0.82	95.4	7.8	1.8	2.0	2040	19.3180

B3 Mounting Dimension

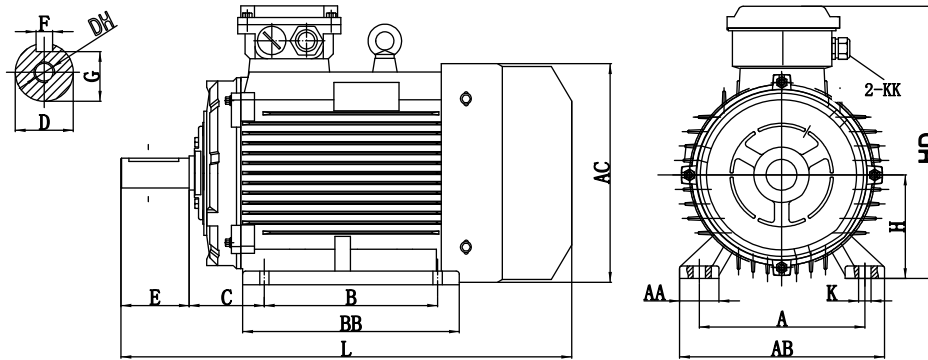

Frame size	poles	Mounting dimensions (mm.)										Overall dimensions (mm.)					
		A	B	C	D	E	F	G	H	K	DH	AB	AC	HD	BB	AA	L
71	2, 4, 6	112	90	45	14	30	5	11	71	7	M5*13	136	139	185	107	24	247
80	2, 4, 6, 8	125	100	50	19	40	6	15.5	80	10	M6*16	158	157	229	131	33	280
90S	2, 4, 6, 8	140	100	56	24	50	8	20	90	10	M8*20	180	176	245	140	36	316
90L	2, 4, 6, 8	140	125	56	24	50	8	20	90	10	M8*20	180	176	245	165	36	340
100L	2, 4, 6, 8	160	140	63	28	60	8	24	100	12	M10*20	198	196	258	175	38	376
112M	2, 4, 6, 8	190	140	70	28	60	8	24	112	12	M10*25	230	220	306	170	45	400
132S	2, 4, 6, 8	216	140	89	38	80	10	33	132	12	M12*30	262	258	340	178	50	441
132M	2, 4, 6, 8	216	178	89	38	80	10	33	132	12	M12*30	262	258	340	216	50	475
160M	2, 4, 6, 8	254	210	108	42	110	12	37	160	15	M16*36	313	311	414	256	65	610
160L	2, 4, 6, 8	254	254	108	42	110	12	37	160	15	M16*36	313	311	414	300	65	655
180M	2, 4, 6, 8	279	241	121	48	110	14	42.5	180	15	M16*36	345	352	450	300	70	690
180L	2, 4, 6, 8	279	279	121	48	110	14	42.5	180	15	M16*36	345	352	450	340	70	730
200L	2, 4, 6, 8	318	305	133	55	110	16	49	200	19	M20*42	386	394	508	355	65	760
225S	4, 6, 8	356	286	149	60	140	18	53	225	19	M20*40	423	442	555	360	75	810
225M	2	356	311	149	55	110	16	49	225	19	M20*40	423	442	555	385	75	805
	4, 6, 8	356	311	149	60	140	18	53	225	19	M20*40	423	442	555	385	75	835
250M	2	406	349	168	60	140	18	53	250	24	M20*40	490	481	615	445	80	930
	4, 6, 8	406	349	168	65	140	18	58	250	24	M20*42	490	481	615	445	80	930
280S	2	457	368	190	65	140	18	58	280	24	M20*40	532	543	675	485	80	985
	4, 6, 8	457	368	190	75	140	20	67.5	280	24	M20*40	532	543	675	485	80	985
280M	2	457	419	190	65	140	18	58	280	24	M20*40	532	543	675	530	80	1035
	4, 6, 8	457	419	190	75	140	20	67.5	280	24	M20*40	532	543	675	530	80	1035
315S	2	508	406	216	65	140	18	58	315	28	M20*42	620	616	850	560	120	1190
	4, 6, 8	508	406	216	80	170	22	71	315	28	M20*40	620	616	850	560	120	1220
315M	2	508	457	216	65	140	18	58	315	28	M20*40	620	616	850	670	120	1300
	4, 6, 8	508	457	216	80	170	22	71	315	28	M20*40	620	616	850	670	120	1330
315L	2	508	508	216	65	140	18	58	315	28	M20*40	620	616	850	670	120	1300
	4, 6, 8	508	508	216	80	170	22	71	315	28	M20*42	620	616	850	670	120	1330
355M	2	610	560	254	75	140	20	67.5	355	28	M20*40	725	694	1000	750	112	1525
	4, 6, 8	610	560	254	95	170	25	86	355	28	M20*40	725	694	1000	750	112	1555
355L	2	610	630	254	75	140	20	67.5	355	28	M20*40	725	694	1000	750	112	1525
	4, 6, 8	610	630	254	95	170	25	86	355	28	M20*40	725	694	1000	750	112	1555
400	4, 6, 8	686	710	280	120	210	32	109	400	35	M20*40	810	850	1085	1085	125	1954

R=0 distance from flange to shaft shoulder

B5 Mounting Dimension

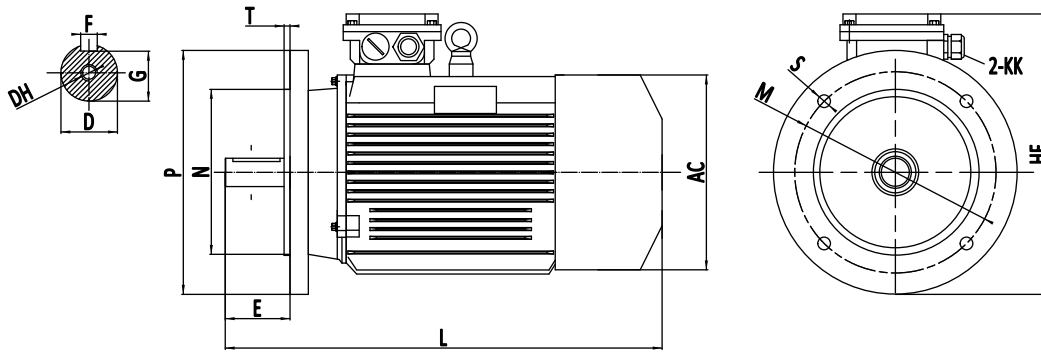

Frame size	Poles	Mounting dimensions (mm.)													Overall dimensions		
		D	E	F	G	H	K	M	N	P	R	S	T	DH	AC	HF	L
71	2, 4, 6, 8	14	30	5	11	71	7	130	110	160	0±1.5	4-Φ10	3.5	M5*13	139	190	247
80	2, 4, 6, 8	19	40	6	15.5	80	10	165	130	200	0±1.5	4-Φ12	3.5	M6*16	168	225	280
90S	2, 4, 6, 8	24	50	8	20	90	10	165	130	200	0±1.5	4-Φ12	3.5	M8*20	193	248	326
90L	2, 4, 6, 8	24	50	8	20	90	10	165	130	200	0±1.5	4-Φ12	3.5	M8*20	193	248	351
100L	2, 4, 6, 8	28	60	8	24	100	12	215	180	250	0±2	4-Φ15	4	M10*20	217	270	376
112M	2, 4, 6, 8	28	60	8	24	112	12	215	180	250	0±2	4-Φ15	4	M10*25	220	292	400
132S	2, 4, 6, 8	38	80	10	33	132	12	265	230	300	0±2	4-Φ15	4	M12*30	258	331	470
132M	2, 4, 6, 8	38	80	10	33	132	12	265	230	300	0±2	4-Φ15	4	M12*30	258	331	510
160M	2, 4, 6, 8	42	110	12	37	160	15	300	250	350	0±3	4-Φ19	5	M16*36	330	414	610
160L	2, 4, 6, 8	42	110	12	37	160	15	300	250	350	0±3	4-Φ19	5	M16*36	330	414	655
180M	2, 4, 6, 8	48	110	14	42.5	180	15	300	250	350	0±3	4-Φ19	5	M16*36	380	447	690
180L	2, 4, 6, 8	48	110	14	42.5	180	15	300	250	350	0±3	4-Φ19	5	M16*36	380	447	730
200L	2, 4, 6, 8	55	110	16	49	200	19	350	300	400	0±3	4-Φ19	5	M20*42	420	505	760
225S	4, 6, 8	60	140	18	53	225	19	400	350	450	0±4	8-Φ19	5	M20*40	470	545	810
225M	2	55	110	16	49	225	19	400	350	450	0±4	8-Φ19	5	M20*40	470	545	805
	4, 6, 8	60	140	18	53	225	19	400	350	450	0±4	8-Φ19	5	M20*40	470	545	835
250M	2	60	140	18	53	250	24	500	450	550	0±4	8-Φ19	5	M20*40	510	615	930
	4, 6, 8	65	140	18	58	250	24	500	450	550	0±4	8-Φ19	5	M20*42	510	615	930
280S	2	65	140	18	58	280	24	500	450	550	0±4	8-Φ19	5	M20*40	580	665	985
	4, 6, 8	75	140	20	67.5	280	24	500	450	550	0±4	8-Φ19	5	M20*40	580	665	985
280M	2	65	140	18	58	280	24	500	450	550	0±4	8-Φ19	5	M20*40	580	665	1035
	4, 6, 8	75	140	20	67.5	280	24	500	450	550	0±4	8-Φ19	5	M20*40	580	665	1035
315S	2	65	140	18	58	315	28	600	550	660	0±4	8-Φ24	6	M20*42	620	845	1190
	4, 6, 8	80	170	22	71	315	28	600	550	660	0±4	8-Φ24	6	M20*40	620	845	1220
315M	2	65	140	18	58	315	28	600	550	660	0±4	8-Φ24	6	M20*40	620	845	1300
	4, 6, 8	80	170	22	71	315	28	600	550	660	0±4	8-Φ24	6	M20*40	620	845	1330
315L	2	65	140	18	58	315	28	600	550	660	0±4	8-Φ24	6	M20*40	620	845	1300
	4, 6, 8	80	170	22	71	315	28	600	550	660	0±4	8-Φ24	6	M20*42	620	845	1330
355M	2	75	140	20	67.5	355	28	740	680	800	0±4	8-Φ24	6	M20*40	700	1000	1525
	4, 6, 8	95	170	25	86	355	28	740	680	800	0±4	8-Φ24	6	M20*40	700	1000	1555
355L	2	75	140	20	67.5	355	28	740	680	800	0±4	8-Φ24	6	M20*40	700	1000	1525
	4, 6, 8	95	170	25	86	355	28	740	680	800	0±4	8-Φ24	6	M20*40	700	1000	1555

R=0 distance from flange to shaft shoulder

B35 Mounting Dimension

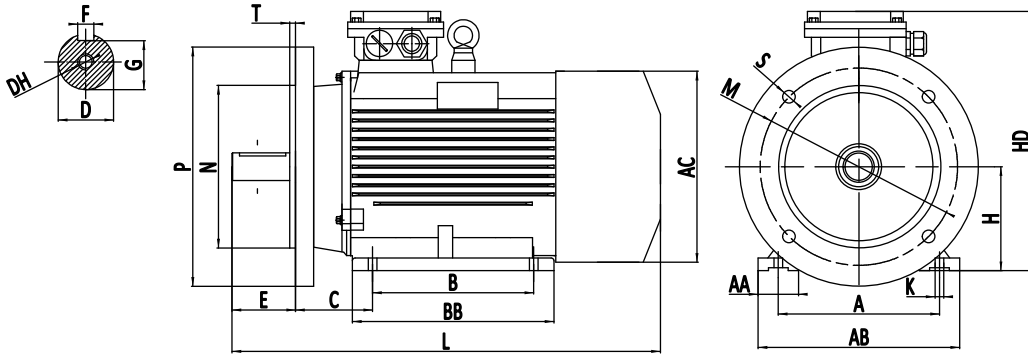

Frame size	poles	Mounting dimensions (mm.)															Overall dimensions (mm.)						
		A	B	C	D	E	F	G	H	K	M	N	P	R	S	T	DH	AB	AC	BB	AA	HD	L
71	2, 4, 6	112	90	45	14	30	5	11	71	7	130	110	160	0±1.5	4-Φ10	3.5	M5*13	136	139	107	24	185	247
80	2, 4, 6, 8	125	100	50	19	40	6	15.5	80	10	165	130	200	0±1.5	4-Φ12	3.5	M6*16	158	157	131	33	229	280
90S	2, 4, 6, 8	140	100	56	24	50	8	20	90	10	165	130	200	0±1.5	4-Φ12	3.5	M8*20	180	176	140	36	245	316
90L	2, 4, 6, 8	140	125	56	24	50	8	20	90	10	165	130	200	0±1.5	4-Φ12	3.5	M8*20	180	176	165	36	245	340
100L	2, 4, 6, 8	160	140	63	28	60	8	24	100	12	215	180	250	0±2	4-Φ15	4	M10*20	198	196	175	38	258	376
112M	2, 4, 6, 8	190	140	70	28	60	8	24	112	12	215	180	250	0±2	4-Φ15	4	M10*25	230	220	170	45	306	400
132S	2, 4, 6, 8	216	140	89	38	80	10	33	132	12	265	230	300	0±2	4-Φ15	4	M12*30	262	258	178	50	340	441
132M	2, 4, 6, 8	216	178	89	38	80	10	33	132	12	265	230	300	0±2	4-Φ15	4	M12*30	262	258	216	50	340	475
160M	2, 4, 6, 8	254	210	108	42	110	12	37	160	15	300	250	350	0±3	4-Φ19	5	M16*36	313	311	256	65	414	610
160L	2, 4, 6, 8	254	254	108	42	110	12	37	160	15	300	250	350	0±3	4-Φ19	5	M16*36	313	311	300	65	414	655
180M	2, 4, 6, 8	279	241	121	48	110	14	42.5	180	15	300	250	350	0±3	4-Φ19	5	M16*36	345	352	300	70	450	690
180L	2, 4, 6, 8	279	279	121	48	110	14	42.5	180	15	300	250	350	0±3	4-Φ19	5	M16*36	345	352	340	70	450	730
200L	2, 4, 6, 8	318	305	133	55	110	16	49	200	19	350	300	400	0±3	4-Φ19	5	M20*42	386	394	355	65	508	760
225S	4, 6, 8	356	286	149	60	140	18	53	225	19	400	350	450	0±4	8-Φ19	5	M20*40	423	442	360	75	555	810
225M	2	356	311	149	55	110	16	49	225	19	400	350	450	0±4	8-Φ19	5	M20*40	423	442	385	75	555	805
	4, 6, 8	356	311	149	60	140	18	53	225	19	400	350	450	0±4	8-Φ19	5	M20*40	423	442	385	75	555	835
250M	2	406	349	168	60	140	18	53	250	24	500	450	550	0±4	8-Φ19	5	M20*40	490	481	445	80	615	930
	4, 6, 8	406	349	168	65	140	18	58	250	24	500	450	550	0±4	8-Φ19	5	M20*42	490	481	445	80	615	930
280S	2	457	368	190	65	140	18	58	280	24	500	450	550	0±4	8-Φ19	5	M20*40	532	543	485	80	675	985
	4, 6, 8	457	368	190	75	140	20	67.5	280	24	500	450	550	0±4	8-Φ19	5	M20*40	532	543	485	80	675	985
280M	2	457	419	190	65	140	18	58	280	24	500	450	550	0±4	8-Φ19	5	M20*40	532	543	530	80	675	1035
	4, 6, 8	457	419	190	75	140	20	67.5	280	24	500	450	550	0±4	8-Φ19	5	M20*40	532	543	530	80	675	1035
315S	2	508	406	216	65	140	18	58	315	28	600	550	660	0±4	8-Φ24	6	M20*42	620	616	560	120	845	1190
	4, 6, 8	508	406	216	80	170	22	71	315	28	600	550	660	0±4	8-Φ24	6	M20*40	620	616	560	120	845	1220
315M	2	508	457	216	65	140	18	58	315	28	600	550	660	0±4	8-Φ24	6	M20*40	620	616	670	120	845	1300
	4, 6, 8	508	457	216	80	170	22	71	315	28	600	550	660	0±4	8-Φ24	6	M20*40	620	616	670	120	845	1330
315L	2	508	508	216	65	140	18	58	315	28	600	550	660	0±4	8-Φ24	6	M20*40	620	616	670	120	845	1300
	4, 6, 8	508	508	216	80	170	22	71	315	28	600	550	660	0±4	8-Φ24	6	M20*42	620	616	670	120	845	1330
355M	2	610	560	254	75	140	20	67.5	355	28	740	680	800	0±4	8-Φ24	6	M20*40	725	694	750	112	1000	1525
	4, 6, 8	610	560	254	95	170	25	86	355	28	740	680	800	0±4	8-Φ24	6	M20*40	725	694	750	112	1000	1555
355L	2	610	630	254	75	140	20	67.5	355	28	740	680	800	0±4	8-Φ24	6	M20*40	725	694	750	112	1000	1525
	4, 6, 8	610	630	254	95	170	25	86	355	28	740	680	800	0±4	8-Φ24	6	M20*40	725	694	750	112	1000	1555

R=0 distance from flange to shaft shoulder

KRUGER Ventilation Group

THAILAND (Regional Headquarters)

KRUGER VENTILATION INDUSTRIES ASIA CO., LTD.

30/159 Moo 1, Sinsakorn Industrial Estate, Chetsadawithi Road, Khok Kham, Mueng, Samuthsakorn 74000, Thailand

Tel: +662 1054298 Fax: +662 0248256-9

Email: mktg@krugerventasia.co.th

Website: www.krugerfan.com

INDIA (Haryana)

KRUGER VENTILATION INDUSTRIES (INDIA) PVT. LTD.

Plant-1 :Khasra No. 150/20/2/1, 151/16/2/2,

Village-Rohad, Bahadurgarh, Jajhjar, Haryana - 124507,

India Plant-2 : Khasra No.: 2-0, 14/3, 4-10, 15/1, 6-2, 20

Area: 4 Kanal 4 Marla, Khewat No.: 1007/868,

Khata No.: 1068, Killa No.: 146/6 (7-12, 7/1)

Village Rohad, Bahadurgarh-Rohtak Road,

Bahadurgarh, District Jhajjar - 124507, Haryana, India

Tel: +91 995 8991 652, +91 998 8991 660, +91 858 6966 303

Email: sales.knl@krugerindia.com

INDIA (Mumbai)

KRUGER VENTILATION INDUSTRIES (INDIA) PVT. LTD.

Village-Kalamgaon, Mumbai-Nashik Highway,

Tal-Shahapur, Dist. Thane- 421 601. Maharashtra, India

Tel. : +91 996 0558 899 / 997 5577 211

Fax : +91 2527 240075

E-mail : sales@krugerindia.com

INDIA (Chennai)

KRUGER VENTILATION INDUSTRIES (INDIA) PVT. LTD.

Plot no : E-23/1, Survey no: 279, SIPCOT Industrial Estate,

Rungattukottai, Sriperumbudur Taluk, Tamilnadu - 602117, India

Tel. : +91 978 9982 290

E-mail : giriprabhu@krugerindia.com

MIDDLE EAST

CONTACT : KRUGER VENTILATION INDUSTRIES (INDIA) PVT. LTD.

Tel. : +91 9766323730 / +91 9975577211

Email : rahul@krugerindia.com

MALAYSIA

KRUVENT INDUSTRIES (M) SDN. BHD.

Lot 850, Jalan Subang 7, Taman Perindustrian Subang,

47500, Subang Jaya, Selangor D.E., Malaysia

Tel: +603 80743399 Fax: +603 80743388

Email: mktg@kruger.com.my

INDONESIA

P.T. KRUGER VENTILATION INDONESIA

Jl. Teuku Umar No. 20, Karawaci,

Tangerang 15115, Indonesia

Tel: +62 21-5512288

Fax: +62 21-5513502

Email: mktg@krugerindo.co.id

AUSTRALIA

S&P-KRUGER AUSTRALIA PTY. LTD.

2 Cunningham St, Moorebank N.S.W. 2170

Tel: +612-98227747

Fax: +612-98227757

Email: info@sandpkruger.com.au

VIETNAM

KRUGER VENTILATION INDUSTRIES (VIETNAM) CO., LTD.

Lot A7, 2-4, C2 Road, Thanh Thanh Cong IZ,

Trang Bang District, Tay Ninh Province, Vietnam

Tel: +84-276 3585200/01/02 Fax: +84-276 3585199

Email: mktg@krugervn.com

CHINA (Shanghai)

SHANGHAI KRUGER VENTILATION CO., LTD.

No. 500 Yuanguo Road, Anting, Jiading District, Shanghai 201814, P.R. China

Tel: +86 21-69573266 Fax: +86 21-69573296

Email: ksh@krugerfan.com.cn

Website: www.krugerfan.com.cn

CHINA (Tianjin)

TIANJIN KRUGER VENTILATION CO., LTD.

Jingjin Science and Technology Park,

Wuqing District, Tianjin 301700, P.R. China

Tel: +86 22-22143480 Fax: +86 22-22143482

Email: ktj@krugerfan.com.cn

CHINA (Guangzhou)

GUANGZHOU KRUGER VENTILATION CO., LTD.

No. 9 Huahui Road, Huashan Town,

Huadu District Guangzhou 510880, P.R. China

Tel: +86 20-66356635 Fax: +86 20-86786001/86786500

Email: kgv@krugerfan.com.cn

CHINA (Wuhan)

WUHAN KRUGER VENTILATION CO., LTD.

No. 805 Huian Avenue, Dongxihu District Wuhan,

Hubei 430040, P.R. China

Tel: +86 27- 83248840

Fax: +86 27- 83261886

Email: kwv@krugerfan.com.cn

HONG KONG

KRUGER VENTILATION (HONG KONG) LIMITED.

Flat E, 8/F, Yeung Yiu Chung (No.8) Industrial Building,

20 Wang Hoi Road, Kowloon Bay, Kowloon, Hong Kong

Tel: +852 22469182 Fax: +852 22469187

Email: info@kruger.com.hk

TAIPEI

KRUGER VENTILATION (TAIWAN) CO., LTD.

No. 157, Ping-an Rd, Hengfeng Village,

Dayuan Shiang Taoyuan County 337, Taiwan

Tel: +886 3-3859119 Fax: +886 3-3859118

Email: sales@krugertwn.com.tw

KOREA

NEOMATE CO., LTD.

80, Seogeunnae-gil, Paltan-myeon, Hwaseong-si,

Gyeonggi-do 18575, Korea

Tel: +82-2-2679-2052 Fax: +82-2-2679-2174

Email: y7890@neomate.co.kr

PHILIPPINES

KRUGER M & E INDUSTRIES CORP.

B3 Welborne Industrial Park, Bancal, Carmona,

Cavite, Philippines 4116

Tel: +63-917-561-9088, +63-917-596-7288,

+63-917-712-8438, +63-917-306-8288 Fax: -

Email: mktg.ph@krugerfan.com

SINGAPORE

KRUGER ENGINEERING PTE. LTD.

2 Venture Drive #20-23, Vision Exchange,

Singapore 608526.

Tel: +65 68631191 Fax: +65 68631151

Email: mktg@krugerfan.com



KRUGER

Kruger Ventilation Industries Asia Co., Ltd.

30/159 Moo 1, Sinsakorn Industrial Estate
Chetsadawithi Road, Khok Kham Mueng,
Samuthsakorn 74000, Thailand
Tel. +662 1054298 - Fax. +662 0248256-9
Website: www.krugerfan.com
CAT081.E0.ED0 May 2026

A member of

Soler&Palau  Ventilation Group